

HANDING OPTIONS

PRIMARY AIR CONNECTION

- ☐ Left Side W/Notched Panel ☒ Right Side W/Notched Panel
☐ Left Top ☐ Right Top

SECONDARY AIR CONNECTION

- ☒ None
☐ Left Side
☐ Right Side

WATER CONNECTION

- ☒ Left Side ☐ Right Side

OPTIONAL SIDE PANEL NOTCH FOR PIPING

- ☒ Notched piping panel both sides (N)
☐ Left side notched piping panel for LX & RX only (L)
☐ Right side notched piping panel for LX & RX only (R)

COIL CIRCUITRY

- ☐ 2 pipe 2 Row (2)
☒ 4 pipe 2 Row (4)

COIL CONNECTION

- ☒ 1/2" MNPT (for field connection to 1/2" FNPT fittings) (M)
 No selection (1/2" bare copper pipe) (N)

Notes: QTY:

Special

Notes

SPECIFICATIONS

-Cabinets constructed of steel and finished with powdercoat paint
 -Internal components constructed of 20ga galvanized steel (unfinished)
 -Units include integral drain pan with 3/8" OD copper condensate drain pipe, caps or piping as needed to be supplied by installing contractor

*Indicates an added cost item

-Additional lead time may be required
 -Contact Carson Solutions for more information

SIZE

LENGTH

- ☐ Size 1500 L = 67 3/4"
☐ Size 2000 L = 87 7/16"

DEPTH

- ☒ 13 1/2" (V) W = 13 1/2" ☐ 13 1/2" (R) W = 13 1/2"
☐ 16 5/8" (S) W = 16 5/8"

INLET SIZE

- ☐ 6" nom. (6) DØ = 5 7/8"
☒ 8" nom. (8) DØ = 7 1/8"

CABINET OPTIONS

(see page 2 for details)

- ☐ Cabinet by Other (0)
☒ Cabinet with Louvered Face Panels (L) (as shown)
☐ Cabinet with Perforated Face Panels* (P)

CABINET FINISH

- ☐ White (1) ☐ Gray (3) ☐ NLA (5) ☐ Other* (PX - Must Specify)
☐ NLA (2) ☐ Dark Gray (4) ☐ Ivory (6)

REAR HEATER

(see page 2 for details)

- ☒ No Rear Heater (as shown above) (0)
☐ Rear Heater Casing* (Requires 16 5/8" Depth Cabinet) (H)

INTERNAL FINISH

- ☐ Galvanized Steel Finish (0)
☒ Internals Painted Black* (F)

INSULATION

- ☒ No Insulation (Standard) (0)
☐ Internal Insulation* (I)
☐ External Insulation* (E)

CONDENSATE TRAY OPTION

- ☒ Galvanized (0)
☐ Stainless Steel* (S)

BASE/KICKPLATE OPTIONS

- ☒ Kickplate same finish as Casing (0)
☐ Black Painted Kickplate* (K)
☐ No Base - Field Supplied (N)

Float switch

- ☒ No Float Switch (0)
☐ With Float Switch and Terminal Block* (F)

Project:

Submittal Date:

Location:

Product Code QLCI-4U2M-ULLTXN0-4-FTxVx8- -F0000

Page

QLCI Cabinet Options

Cabinet by Others (O)

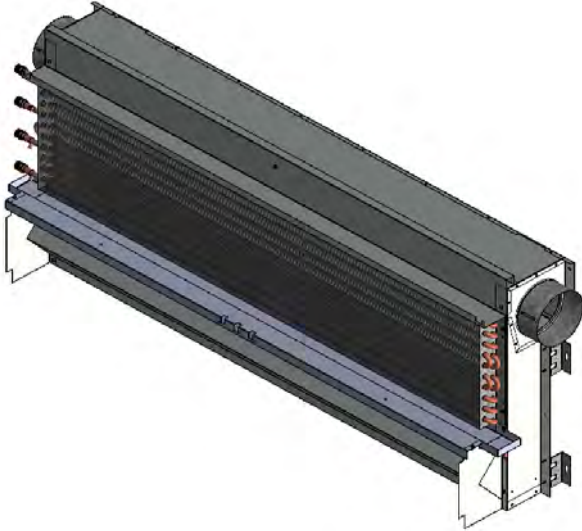

Cabinet by Carson Solutions - Louvered Panels (L)

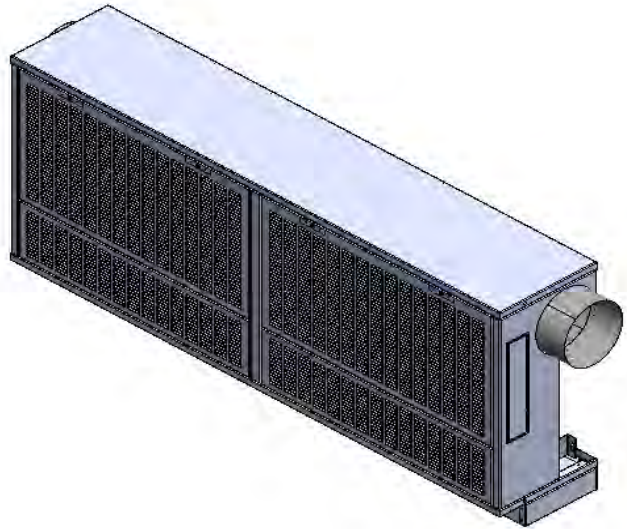

Cabinet by Carson Solutions - Perforated Panels (P)

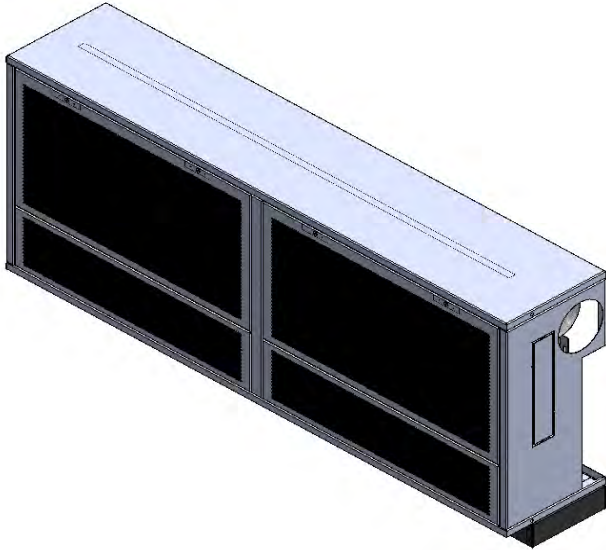

Cabinet by Carson Solutions - Louvered Panels (L) & Rear Heat (H)

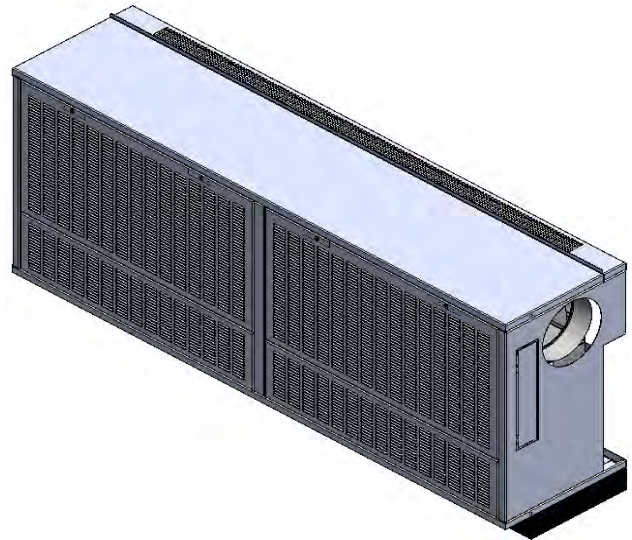

Double Mounting Bracket (DB-MB) Smart Submittal for QLCI Terminals

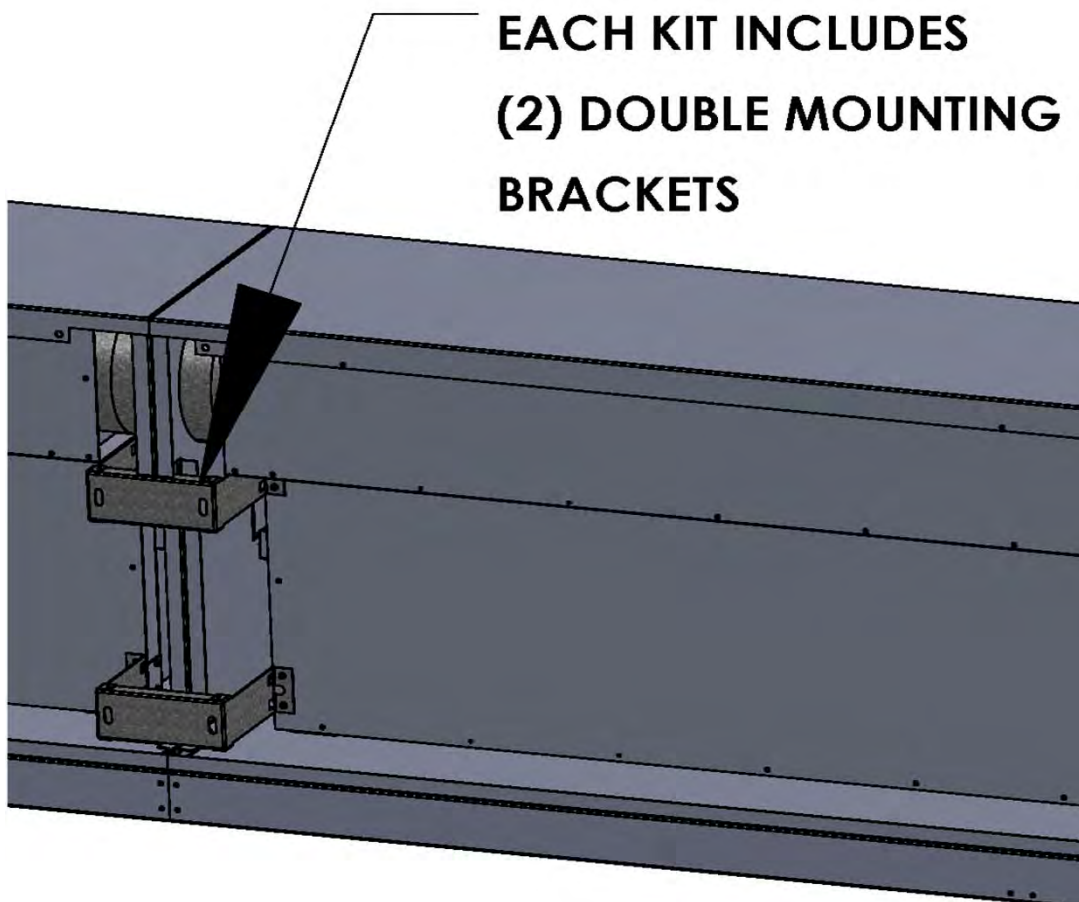

**EACH KIT INCLUDES
 (2) DOUBLE MOUNTING
 BRACKETS**

Tags: QTY:

DEPTH (W)

- ☐ 13½" (R)
☐ 16⅝"* (S)

**Special
 Notes**

SPECIFICATIONS

- Constructed of 16ga Galvanized Steel
- Mounting brackets for assembling multiple QLCI units together before putting them up against the wall
- Allows piping to be connected and attached to the back of the QLCI's

***Indicates an added cost item.**

- Additional lead time may be required
- Contact Carson Solutions for more information
- ***Custom sizes available***

Project:

Submittal Date:

Location:

Product Code DB-MB-

Page

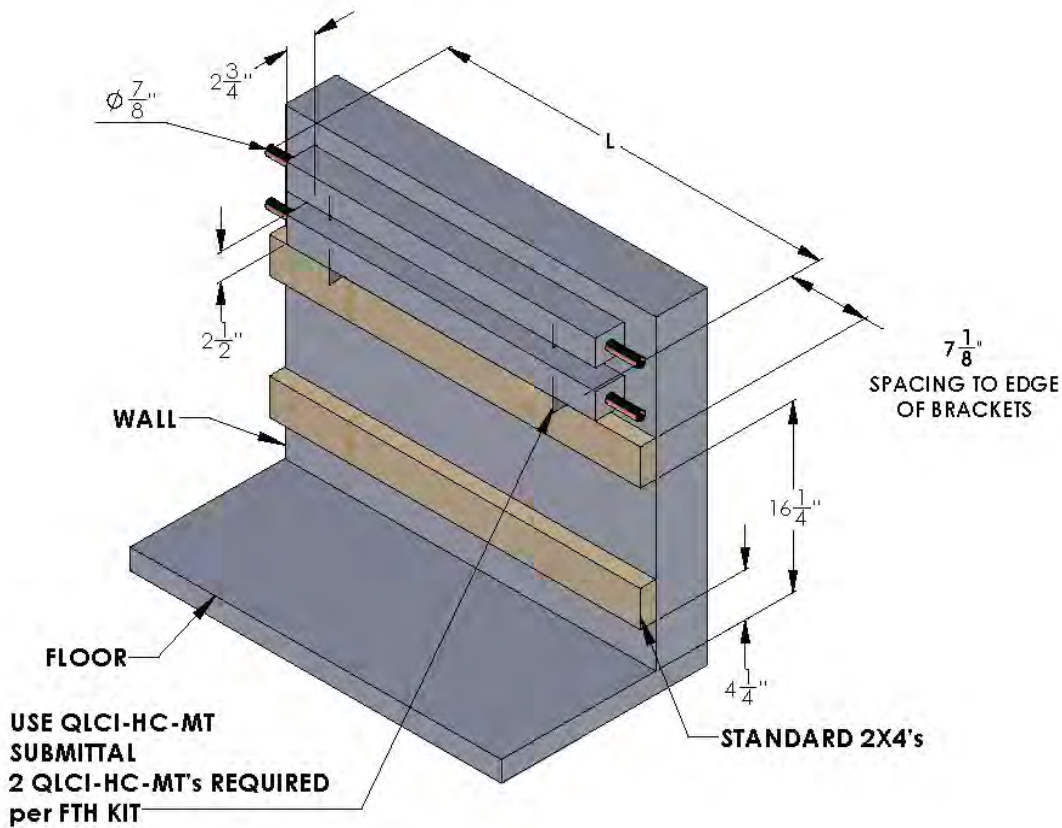

Tags: QTY:

Special
Notes

SPECIFICATIONS

- Each kit comes with two H-3 Fin Tube Coils
- Each kit requires two QLCI-HC-MT brackets
- Use QLCI-HC-MT submittal to order brackets
- Wall mounting hardware by Others

LENGTH (L)

- ☐ Length 4FT
- ☐ Length 5FT
- ☐ Length 6FT
- ☐ Length 7FT
- ☐ Length 8FT

Project: _____

Submittal Date: _____

Location: _____

Product Code FTH-__

Page

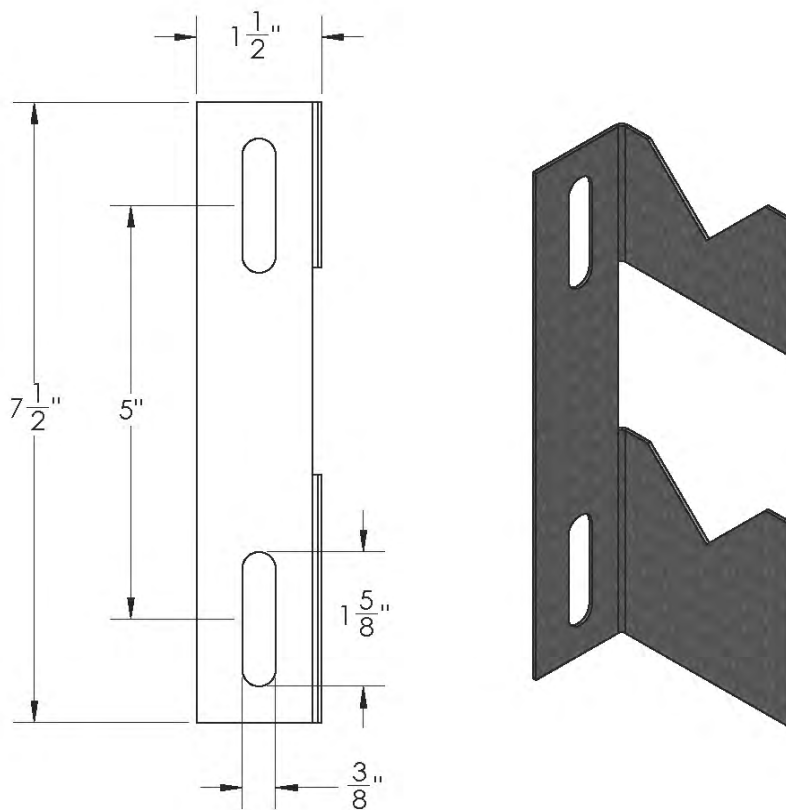

| | |
|--|-------------|
| Tags: | QTY: |
| | |
| Special Notes | |
| SPECIFICATIONS | |
| -Total of brackets shipped together in same box -Total of QLCI-HC-MT brackets to be it's own line item on PO -18ga Galv construction | |
| | |

| | |
|--|--|
| | |
|--|--|

| | | | | |
|---------------------|---|---------------------|-------------------|-------------|
| Project: _____ | Submittal Date: _____ | | | |
| Location: _____ | <table border="1"> <tr> <td>Product Code</td> <td>QLCI-HC-MT</td> <td>Page</td> </tr> </table> | Product Code | QLCI-HC-MT | Page |
| Product Code | QLCI-HC-MT | Page | | |

Basic Bookcase Section (BBS) Smart Submittal for QLCI Terminals

Standard BBS

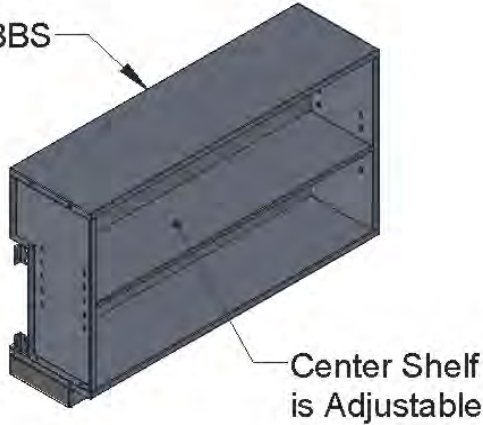

Removable Rear
Heater Top Panel
For BBS-S-H

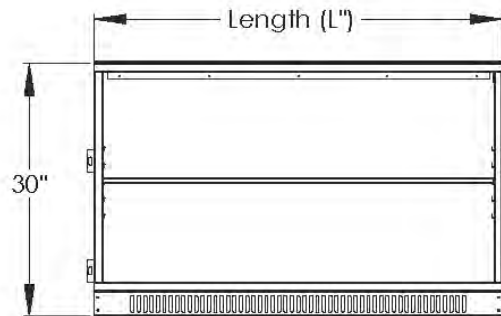
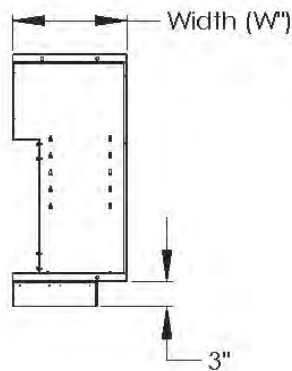
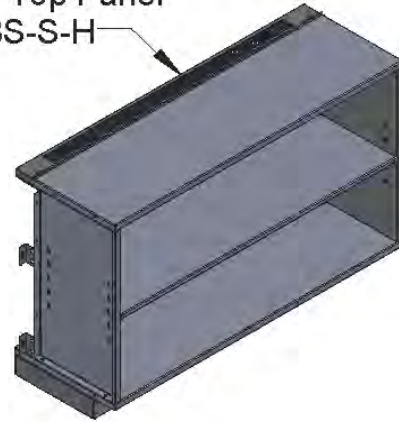

Tags: QTY:

Special Notes

SPECIFICATIONS

- Cabinets constructed of 16ga steel and finished with powdercoat paint
- Both ends notched for pipework passage
- Adjustable center shelf

*Indicates an added cost item

- Additional lead time may be required
- Contact Carson Solutions for more information
- ***Custom sizes available***

LENGTH (L)

- ☐ Size 24"
☐ Size 30"

- ☐ Size 36"
☐ Size 42"
☐ Size 48"

DEPTH (W)

- ☐ 13½" (R)
☐ 16⅝" (S)

- ☐ 13½" (V)

REAR HEATER

- ☐ No Rear Heater (as shown above) (0)
☐ Rear Heater Casing* (Requires 16⅝" Depth Cabinet) (H)

CABINET FINISH

- ☐ White (1) ☐ Gray (3) ☐ NLA (5) ☐ Other* (PX - Must Specify)
☐ NLA (2) ☐ Dark Gray (4) ☐ Ivory (6)

BASE/KICKPLATE OPTIONS

- ☐ Kick plate same finish as Casing (0)
☐ Black Painted Kick plate* (K)
☐ No Base - Field Supplied (N)

Project: _____

Submittal Date: _____

Location: _____

Product Code BBS- _ _ _ _ _

Page

Basic Bookcase Section (BBS-54) Smart Submittal for QLCI Terminals

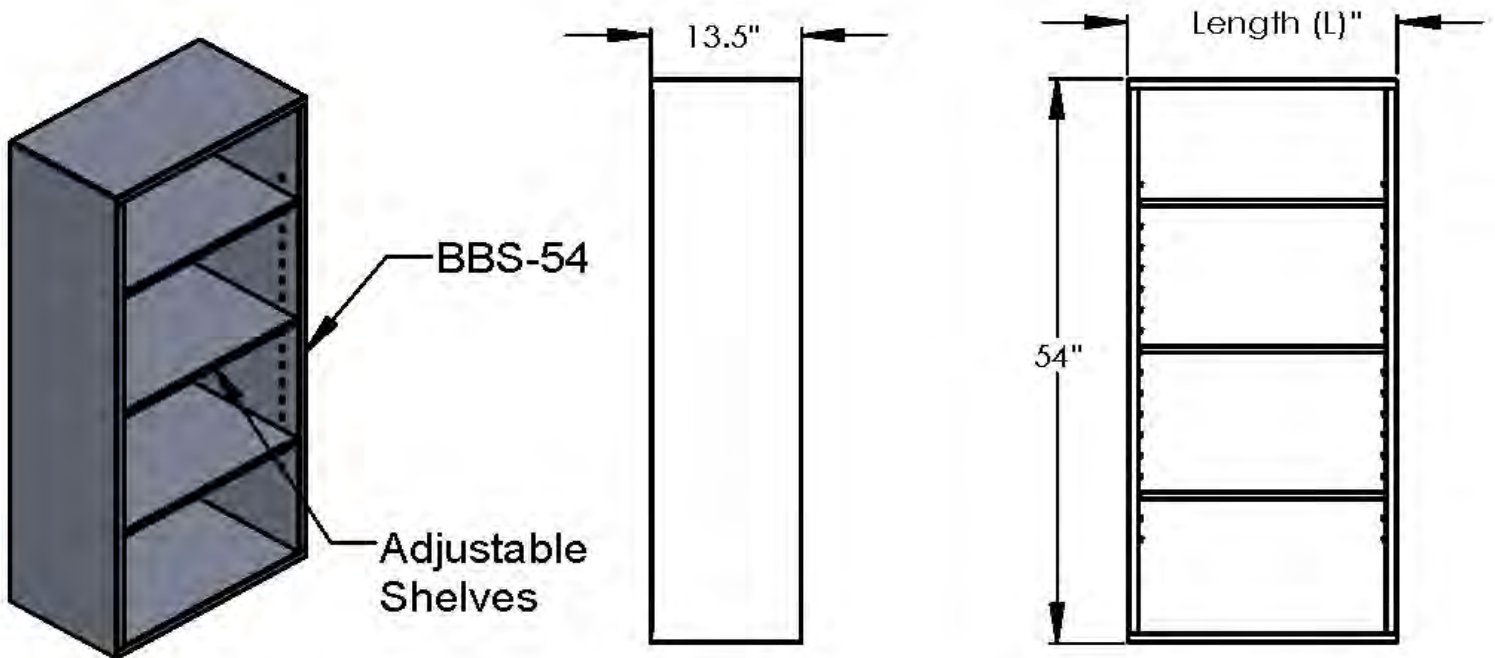

| | | | |
|--|--|---|--|
| Tags: | | QTY: | |
| | | | |
| Special Notes | | | |
| SPECIFICATIONS -Cabinets constructed of 16ga steel and finished with powdercoat paint -Place on top of other 30" tall cabinets -Adjustable center shelf -Attached to back wall *Indicates an added cost item -Additional lead time may be required -Contact Carson Solutions for more information ***Custom sizes available*** | | | |
| LENGTH (L) <input type="checkbox"/> Size 24" <input type="checkbox"/> Size 30" DEPTH (W) <input type="checkbox"/> 13½" (R) | | <input type="checkbox"/> Size 36" <input type="checkbox"/> Size 42" <input type="checkbox"/> Size 48" | |
| REAR HEATER <input type="checkbox"/> No Rear Heater (as shown above) (0) | | | |
| CABINET FINISH <input type="checkbox"/> White (1) <input type="checkbox"/> Gray (3) <input type="checkbox"/> NLA (5) <input type="checkbox"/> Other* (PX - Must Specify) <input type="checkbox"/> NLA (2) <input type="checkbox"/> Dark Gray (4) <input type="checkbox"/> Ivory (6) | | | |
| BASE/KICKPLATE OPTIONS <input type="checkbox"/> No Base - Field Supplied (N) | | | |

| | | | |
|-----------------|------------------------------|-----------------------|------------|
| Project: _____ | | Submittal Date: _____ | |
| Location: _____ | Product Code BBS-54-_-_-_-_- | | Page _____ |

Basic Bookcase Section (BBS-84) Smart Submittal for QLCI Terminals

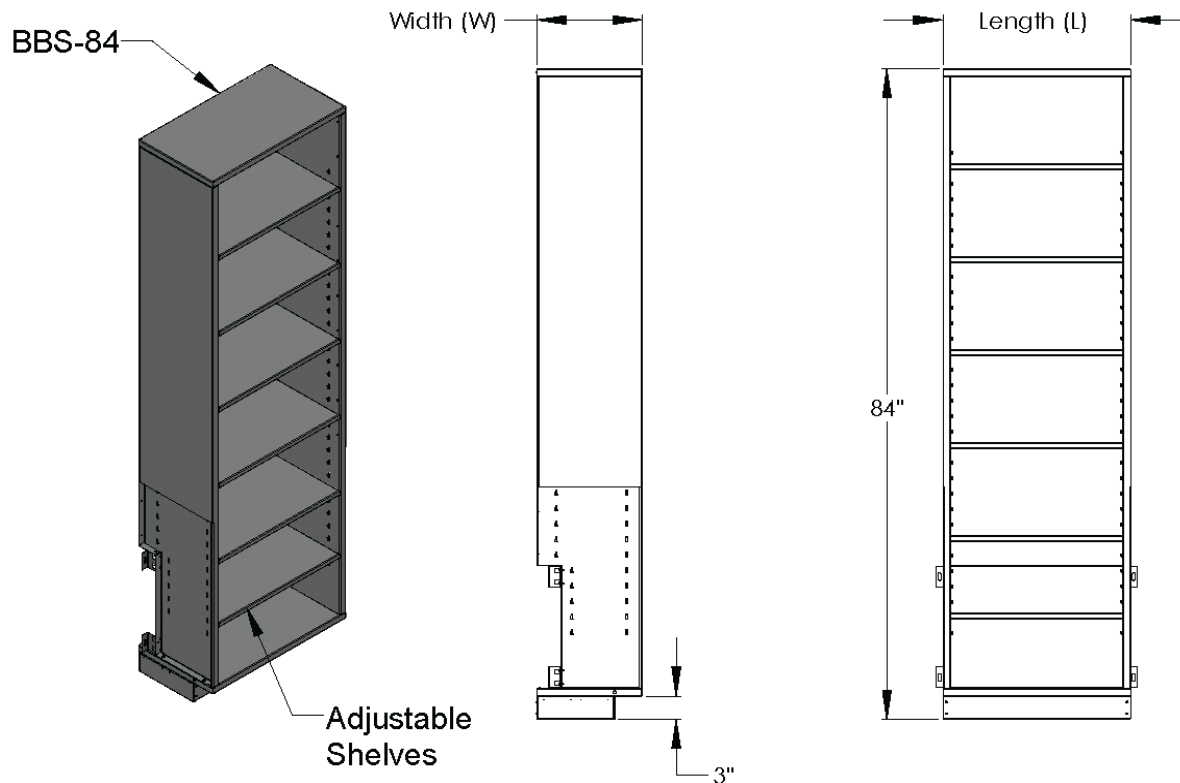

Tags: QTY:

Special Notes

SPECIFICATIONS

- Cabinets constructed of 16ga steel and finished with powdercoat paint
- Both ends notched for pipework passage
- Adjustable center shelf

*Indicates an added cost item

- Additional lead time may be required
- Contact Carson Solutions for more information
- ***Custom sizes available***

LENGTH (L)

- ☐ Size 24"
☐ Size 30"

- ☐ Size 36"
☐ Size 42"
☐ Size 48"

DEPTH (W)

- ☐ 13½" (R)
☐ 16⅝" (S)

REAR HEATER

- ☐ No Rear Heater (as shown above) (0)

CABINET FINISH

- ☐ White (1) ☐ Gray (3) ☐ NLA (5) ☐ Other* (PX - Must Specify)
☐ NLA (2) ☐ Dark Gray (4) ☐ Ivory (6)

BASE/KICKPLATE OPTIONS

- ☐ Kick plate same finish as Casing (0)
☐ Black Painted Kick plate* (K)
☐ No Base - Field Supplied (N)

Project:

Submittal Date:

Location:

Product Code BBS-84- - - - -

Page

Basic Bookcase Section (BBS-84-F) Smart Submittal for QLCI Terminals

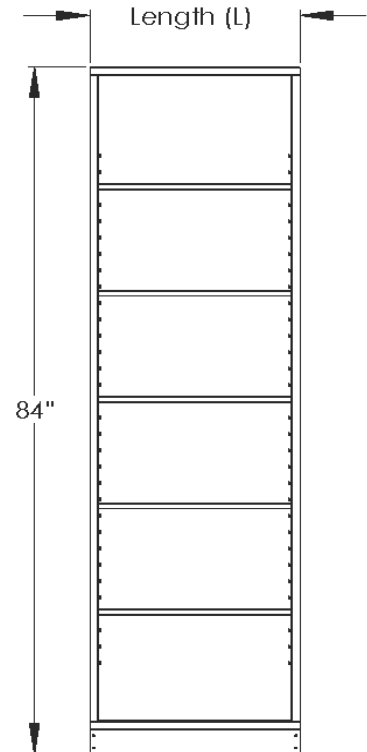
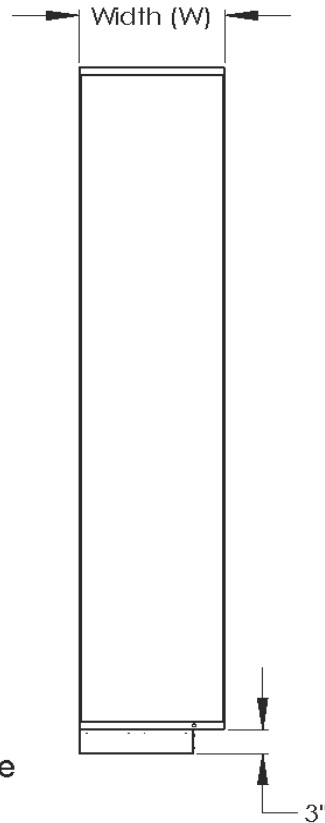
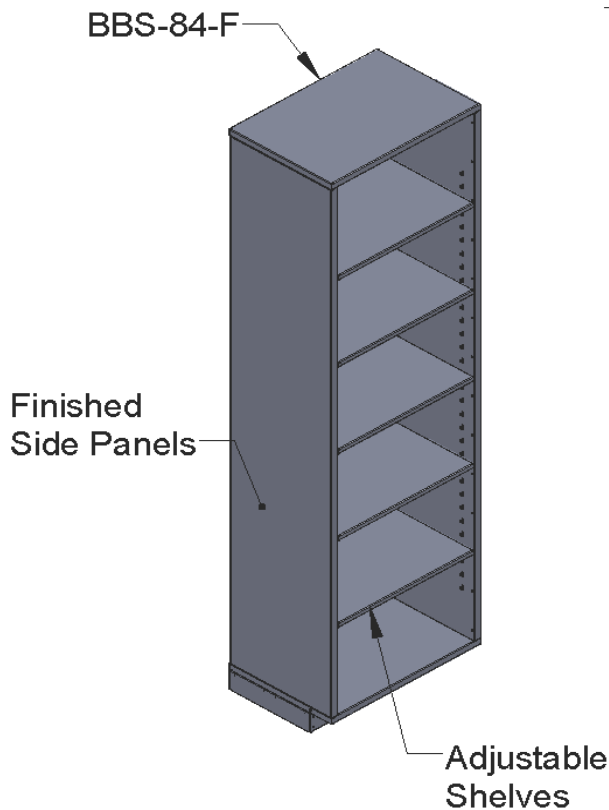

Tags: QTY:

Special Notes

SPECIFICATIONS

- Cabinets constructed of 16ga steel and finished with powdercoat paint
- Both ends notched for pipework passage
- Adjustable center shelf

*Indicates an added cost item

- Additional lead time may be required
- Contact Carson Solutions for more information
- ***Custom sizes available***

LENGTH (L)

- ☐ Size 24"
- ☐ Size 30"

- ☐ Size 36"
- ☐ Size 42"
- ☐ Size 48"

DEPTH (W)

- ☐ 13½" (R)
- ☐ 16⅝" (S)

REAR HEATER

- ☐ No Rear Heater (as shown above) (0)

CABINET FINISH

- ☐ White (1)
- ☐ Gray (3)
- ☐ NLA (5)
- ☐ Other* (PX - Must Specify)
- ☐ NLA (2)
- ☐ Dark Gray (4)
- ☐ Ivory (6)

BASE/KICKPLATE OPTIONS

- ☐ Kick plate same finish as Casing (0)
- ☐ Black Painted Kick plate* (K)
- ☐ No Base - Field Supplied (N)

Project:

Submittal Date:

Location:

Product Code BBS-84-F- - - - -

Page

Ducted Bookcase Section (DBS) Smart Submittal for QLCI Terminals

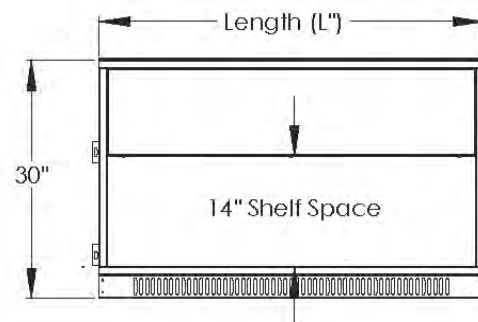
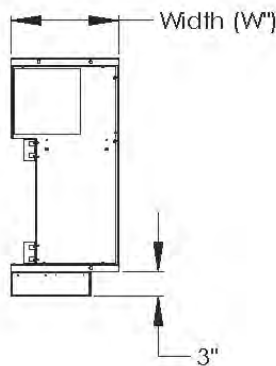
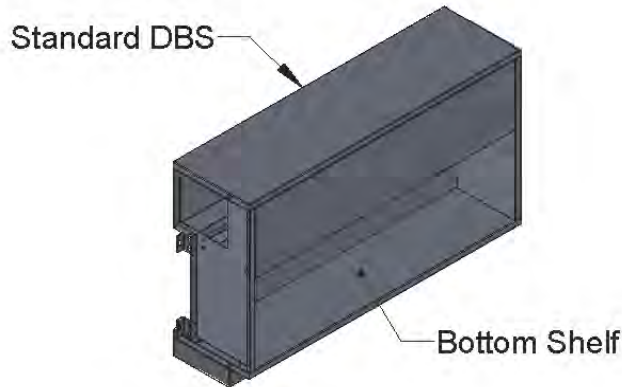

Tags: QTY:

Special Notes

SPECIFICATIONS

- Cabinets constructed of 16ga steel and finished with powdercoat paint
- Both ends notched for pipework passage
- Duct passage
- Fixed bottom shelf

*Indicates an added cost item

- Additional lead time may be required
- Contact Carson Solutions for more information
- ***Custom sizes available***

LENGTH (L)

- ☐ Size 24"
☐ Size 30"

- ☐ Size 36"
☐ Size 42"
☐ Size 48"

DEPTH (W)

- ☐ 13½" (R)
☐ 16⅝" (S)

- ☐ 13½" (V)

REAR HEATER

- ☐ No Rear Heater (as shown above) (0)
☐ Rear Heater Casing* (Requires 16⅝" Depth Cabinet) (H)

CABINET FINISH

- ☐ White (1) ☐ Gray (3) ☐ NLA (5) ☐ Other* (PX - Must Specify)
☐ NLA (2) ☐ Dark Gray (4) ☐ Ivory (6)

BASE/KICKPLATE OPTIONS

- ☐ Kick plate same finish as Casing (0)
☐ Black Painted Kick plate* (K)
☐ No Base - Field Supplied (N)

Project: _____

Submittal Date: _____

Location: _____

Product Code DBS- _ _ _ _

Page

Basic Bookcase Section (DBS-84) Smart Submittal for QLCI Terminals

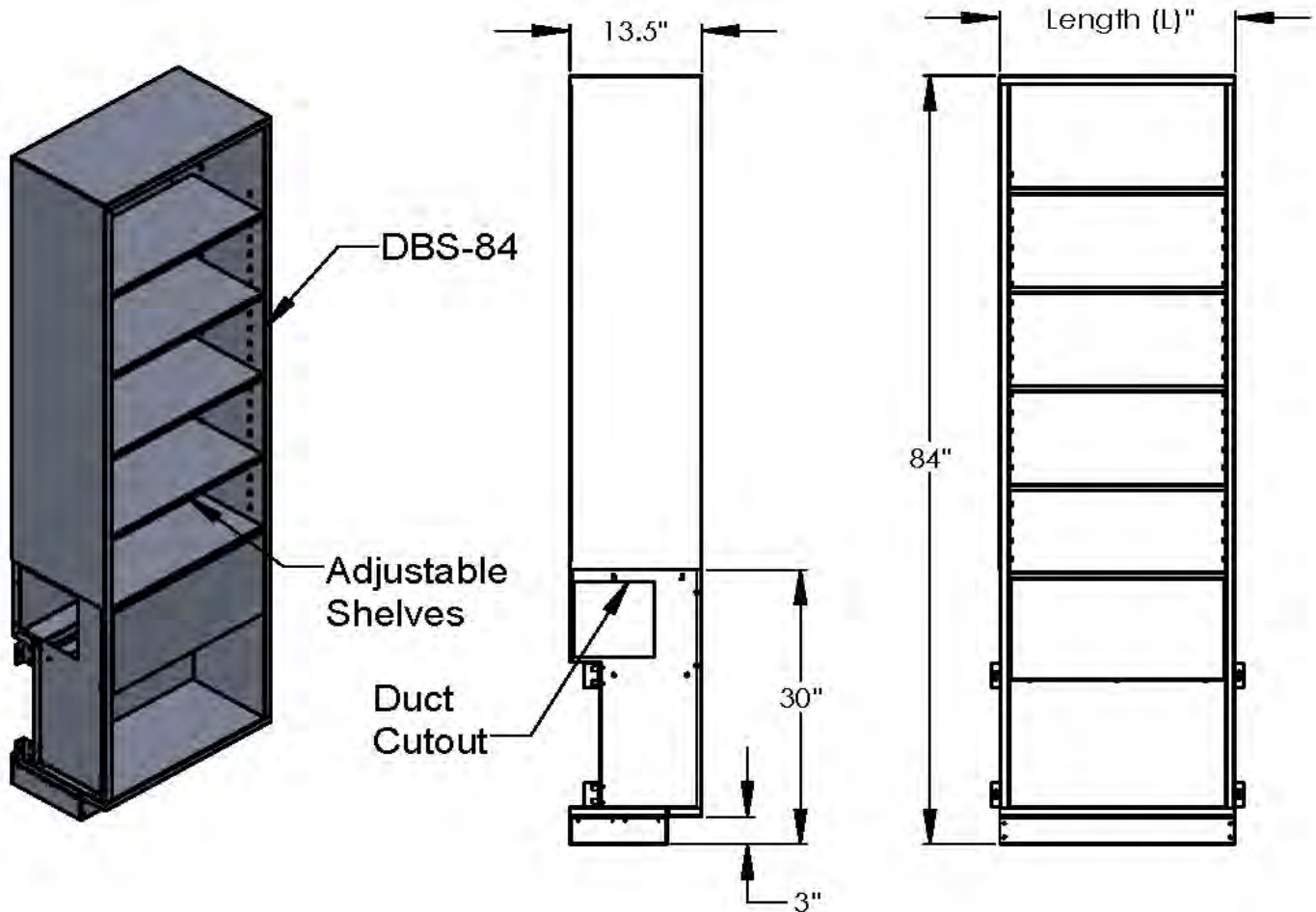

Tags: QTY:

Special Notes

SPECIFICATIONS

- Cabinets constructed of 16ga steel and finished with powdercoat paint
- Both ends notched for pipework passage
- Adjustable center shelf
- Duct passage

*Indicates an added cost item

- Additional lead time may be required
- Contact Carson Solutions for more information
- ***Custom sizes available***

LENGTH (L)

- ☐ Size 24"
- ☐ Size 30"

- ☐ Size 36"
- ☐ Size 42"
- ☐ Size 48"

DEPTH (W)

- ☐ 13½" (R)

REAR HEATER

- ☐ No Rear Heater (as shown above) (0)

CABINET FINISH

- ☐ White (1)
- ☐ Gray (3)
- ☐ NLA (5)
- ☐ Other* (PX - Must Specify)
- ☐ NLA (2)
- ☐ Dark Gray (4)
- ☐ Ivory (6)

BASE/KICKPLATE OPTIONS

- ☐ Kick plate same finish as Casing (0)
- ☐ Black Painted Kick plate* (K)
- ☐ No Base - Field Supplied (N)

Project: _____

Submittal Date: _____

Location: _____

Product Code DBS-84- - - - -

Page

Cubby Hole Storage (CHS) Smart Submittal for QLCI Terminals

CHS
In-Line
With Base

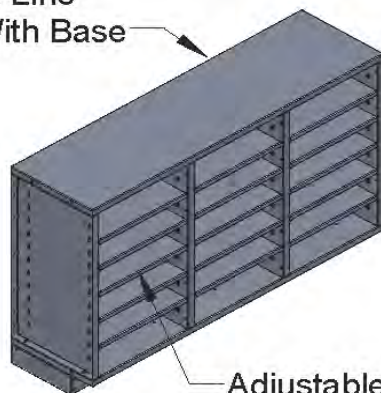

CHS
Top Mounted
Without Base

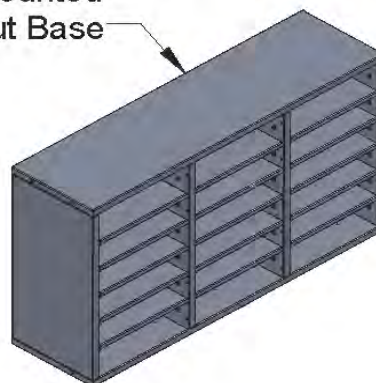

Adjustable Shelves

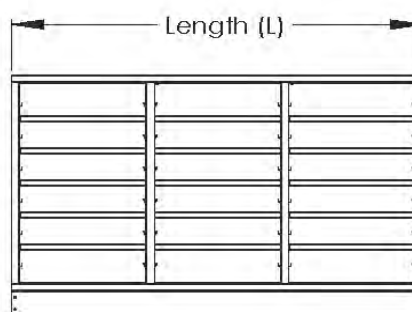
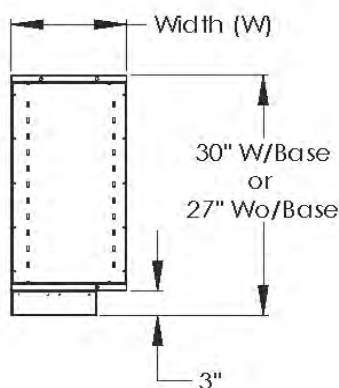

Tags: QTY:

Special Notes

SPECIFICATIONS

- Cabinets constructed of 16ga steel and finished with powdercoat paint
- 15 Adjustable shelves, Maximum of 18 cubby holes
- CHS with base can be mounted in-line with QLCI's
- CHS without base can be mounted on top of another cabinet

*Indicates an added cost item.

- Additional lead time may be required
- Contact Carson Solutions for more information
- ***Custom sizes available***

LENGTH (L)

- ☐ Size 48"
- ☐ Size 60"

DEPTH (W)

- ☐ 13½" (R)
- ☐ 16⅝" (S)

CABINET FINISH

- ☐ White (1)
- ☐ Gray (3)
- ☐ NLA (5)
- ☐ Other* (PX - Must Specify)
- ☐ NLA (2)
- ☐ Dark Gray (4)
- ☐ Ivory (6)

BASE/KICKPLATE OPTIONS

- ☐ Kick plate same finish as Casing (0)
- ☐ Black Painted Kick plate* (K)
- ☐ No Base - Stand alone or sits on top of casing (N)

Project:

Submittal Date:

Location:

Product Code CHS- - - -

Page

End Panel (EP) Smart Submittal for QLCI Terminals

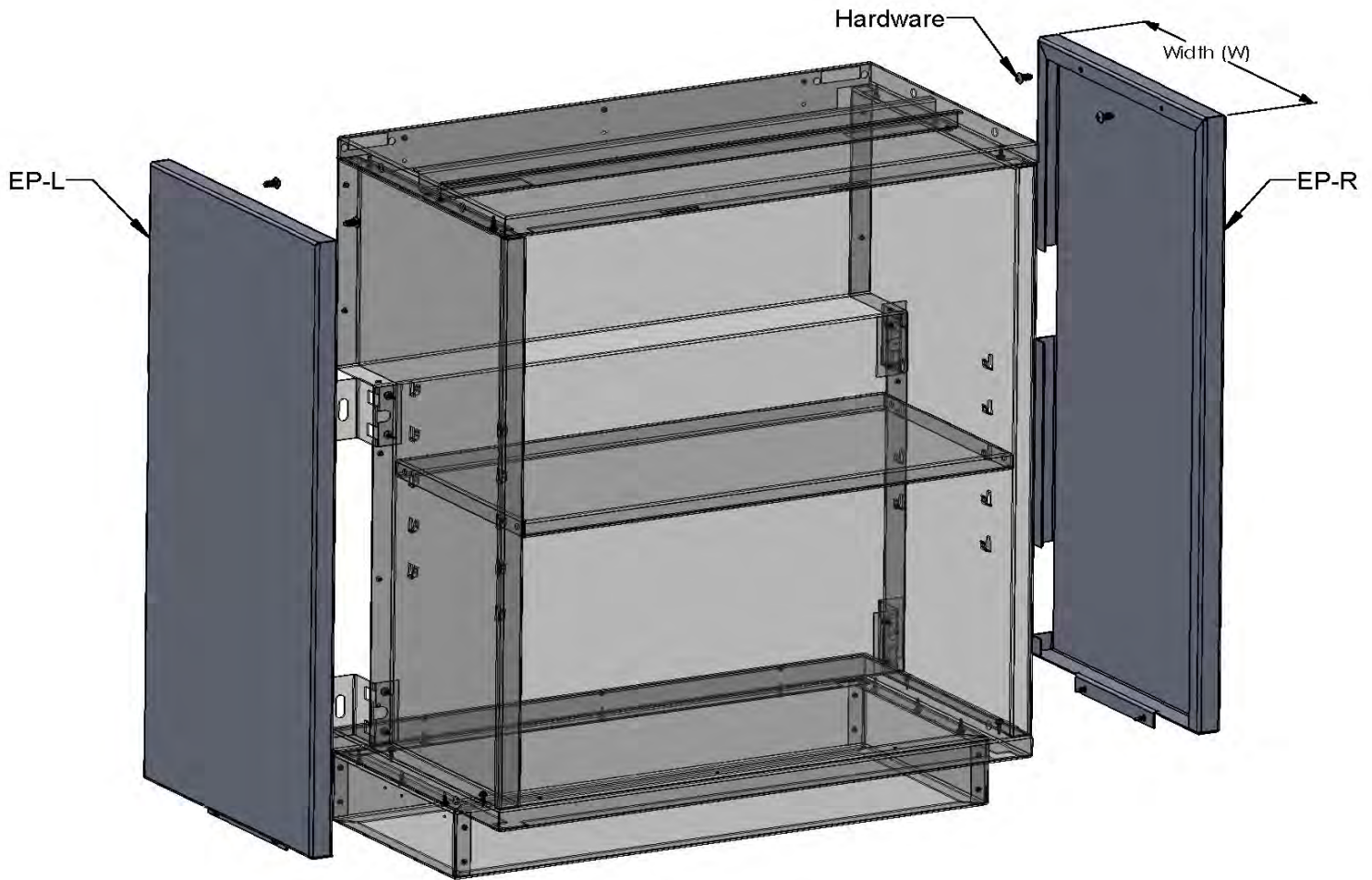

| | | | |
|--|--|---|--|
| Tags: | | QTY: | |
| Special Notes | | DEPTH (W) <input type="checkbox"/> 13½" (R) <input type="checkbox"/> 16⅝"* (S) | |
| | | Handing <input type="checkbox"/> Left (L) <input type="checkbox"/> Right (R) | |
| SPECIFICATIONS | | CABINET FINISH | |
| -End Panels constructed of 16ga steel and finished with powdercoat paint -For use to cap off BBS's or DBS's units at the end of a run -Can also be used to cap off EP's and or QLCI's -Mounting hardware included | | <input type="checkbox"/> White (1) <input type="checkbox"/> Gray (3) <input type="checkbox"/> NLA (5) <input type="checkbox"/> Other* (PX - Must Specify) <input type="checkbox"/> NLA (2) <input type="checkbox"/> Dark Gray (4) <input type="checkbox"/> Ivory (6) | |
| *Indicates an added cost item. -Additional lead time may be required -Contact Carson Solutions for more information ***Custom sizes available*** | | | |

| | |
|-----------------|-----------------------------|
| Project: _____ | Submittal Date: _____ |
| Location: _____ | Product Code EP- _ _ _ Page |

Basic Filler Section (BFS) Smart Submittal for QLCI Terminals

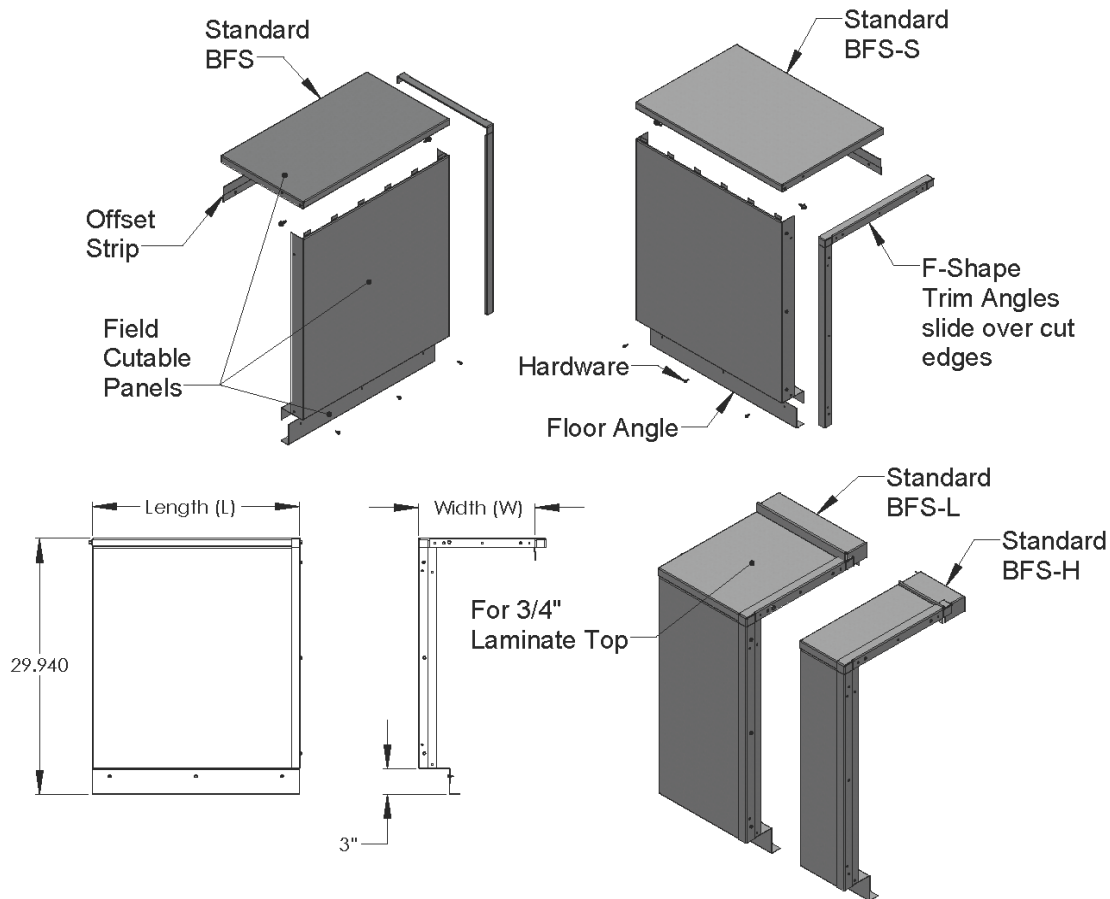

Tags: QTY:

Special
Notes

SPECIFICATIONS

-Cabinets constructed of 16ga steel and finished with powdercoat paint
-Horizontal fill section for use with QLCI, field cutable
-Includes floor angle, wall offset strip, and hardware

*Indicates an added cost item.

-Additional lead time may be required
-Contact Carson Solutions for more information
Custom sizes available

LENGTH (L)

- | | |
|-----------------------------------|-----------------------------------|
| <input type="checkbox"/> Size 6" | <input type="checkbox"/> Size 36" |
| <input type="checkbox"/> Size 12" | <input type="checkbox"/> Size 42" |
| <input type="checkbox"/> Size 18" | <input type="checkbox"/> Size 48" |
| <input type="checkbox"/> Size 24" | <input type="checkbox"/> Size 60" |
| <input type="checkbox"/> Size 30" | |

DEPTH (W)

- | | |
|-----------------------------------|--|
| <input type="checkbox"/> 13½" (R) | <input type="checkbox"/> 16½" (H) Rear Heat |
| <input type="checkbox"/> 16½" (S) | <input type="checkbox"/> 16½" (L) Rear Heat for Laminate Top |

CABINET FINISH

- | | | | |
|------------------------------------|--|------------------------------------|---|
| <input type="checkbox"/> White (1) | <input type="checkbox"/> Gray (3) | <input type="checkbox"/> NLA (5) | <input type="checkbox"/> Other* (PX - Must Specify) |
| <input type="checkbox"/> NLA (2) | <input type="checkbox"/> Dark Gray (4) | <input type="checkbox"/> Ivory (6) | |

BASE/KICKPLATE OPTIONS

- ☐ Kick plate same finish as Casing (0)
☐ Black Painted Kick plate* (K)
☐ No Base - Field Supplied (N)

Project: _____

Submittal Date: _____

Location: _____

Product Code BFS- _ _ _ _

Page

Basic Utility Compartment (BUC) Smart Submittal for QLCI Terminals

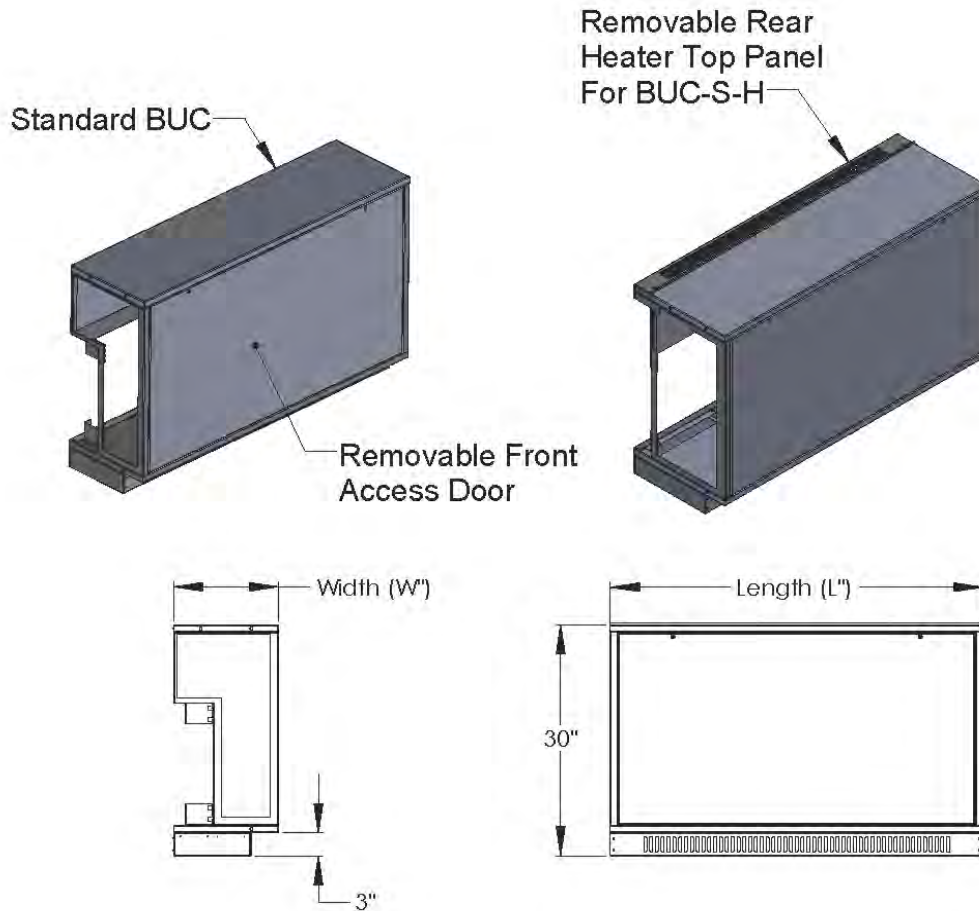

| | | | |
|---|--|---|--|
| Tags: | | QTY: | |
| <p>LENGTH (L)</p> <p><input type="checkbox"/> Size 12" <input type="checkbox"/> Size 30" <input type="checkbox"/> Size 48"</p> <p><input type="checkbox"/> Size 18" <input type="checkbox"/> Size 36"</p> <p><input type="checkbox"/> Size 24" <input type="checkbox"/> Size 42"</p> | | | |
| <p>DEPTH (W)</p> <p><input type="checkbox"/> 13½" (R) <input type="checkbox"/> 13½" (V)</p> <p><input type="checkbox"/> 16⅝" (S)</p> | | | |
| <p>REAR HEATER</p> <p><input type="checkbox"/> No Rear Heater (as shown above) (0)</p> <p><input type="checkbox"/> Rear Heater Casing* (Requires 16⅝" Depth Cabinet) (H)</p> | | | |
| <p>CABINET FINISH</p> <p><input type="checkbox"/> White (1) <input type="checkbox"/> Gray (3) <input type="checkbox"/> NLA (5) <input type="checkbox"/> Other* (PX - Must Specify)</p> <p><input type="checkbox"/> NLA (2) <input type="checkbox"/> Dark Gray (4) <input type="checkbox"/> Ivory (6)</p> | | | |
| <p>BASE/KICKPLATE OPTIONS</p> <p><input type="checkbox"/> Kick plate same finish as Casing (0)</p> <p><input type="checkbox"/> Black Painted Kick plate* (K)</p> <p><input type="checkbox"/> No Base - Field Supplied (N)</p> | | | |
| <p>Special Notes</p> <p>SPECIFICATIONS</p> <p>-Cabinets constructed of 16ga steel and finished with powdercoat paint</p> <p>-Both ends notched for pipework passage</p> <p>-Removable access door for access to piping and ductwork feeding adjacent QLCI terminals</p> | | <p>*Indicates an added cost item.</p> <p>-Additional lead time may be required</p> <p>-Contact Carson Solutions for more information</p> <p>***Custom sizes available***</p> | |

| | |
|-----------------|----------------------------------|
| Project: _____ | Submittal Date: _____ |
| Location: _____ | Product Code BUC- _ _ _ _ _ Page |

Basic Utility Compartment (BUC-TE) Smart Submittal for QLCI Terminals

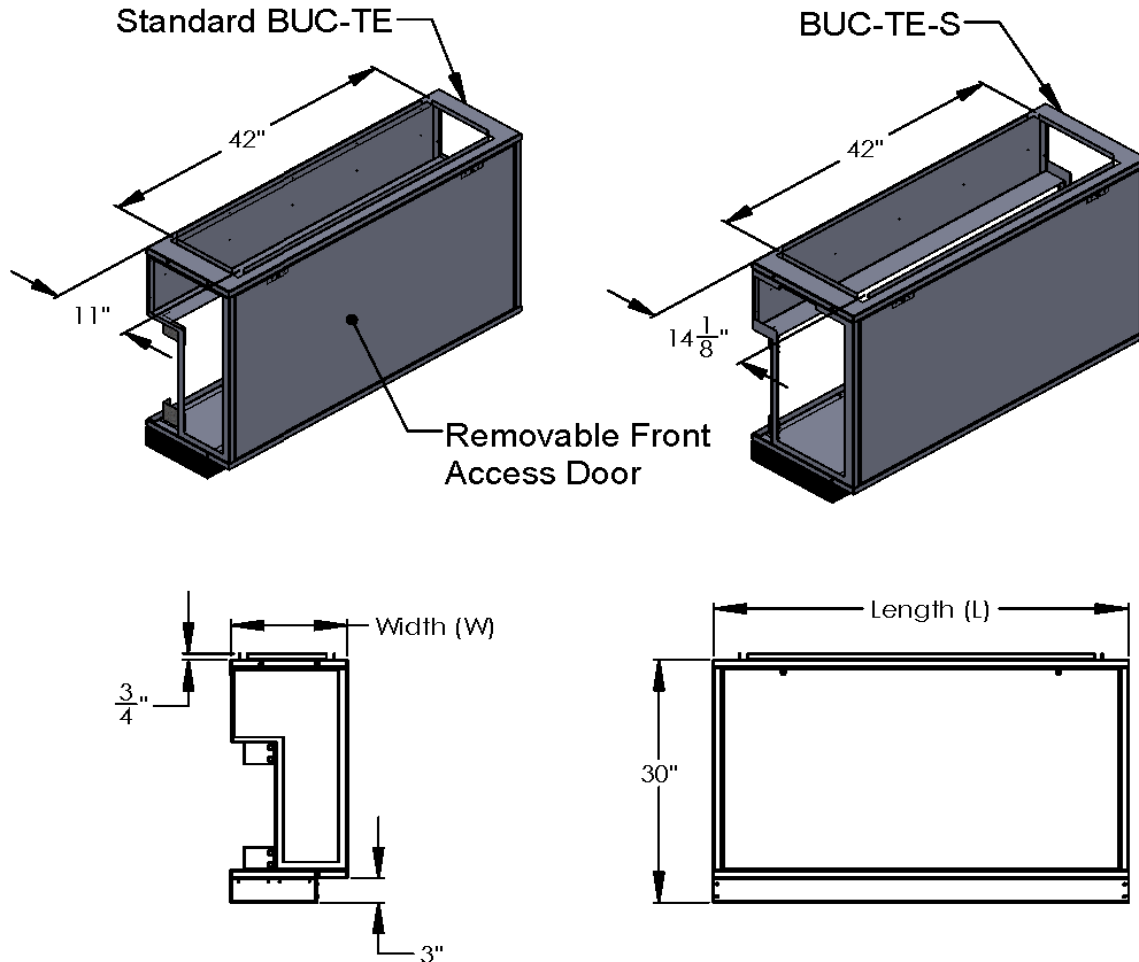

| | | | |
|---|-------------|--|--|
| Tags: | QTY: | LENGTH (L) <input type="checkbox"/> Size 18" <input type="checkbox"/> Size 36" <input type="checkbox"/> Size 24" <input type="checkbox"/> Size 42" <input type="checkbox"/> Size 30" <input type="checkbox"/> Size 48" | |
| Special Notes | | | |
| SPECIFICATIONS -Cabinets constructed of 16ga steel and finished with powdercoat paint -Both ends notched for pipework passage, top entry -Removable access door for access to piping and ductwork feeding adjacent QLCI terminals | | DEPTH (W) <input type="checkbox"/> 13 1/2" (R) <input type="checkbox"/> 16 5/8" (S) | |
| *Indicates an added cost item. -Additional lead time may be required -Contact Carson Solutions for more information ***Custom sizes available*** | | REAR HEATER (Not Available) <input type="checkbox"/> No Rear Heater (as shown above) (0) | |
| | | CABINET FINISH <input type="checkbox"/> White (1) <input type="checkbox"/> Gray (3) <input type="checkbox"/> NLA (5) <input type="checkbox"/> Other* (PX - Must Specify) <input type="checkbox"/> NLA (2) <input type="checkbox"/> Dark Gray (4) <input type="checkbox"/> Ivory (6) | |
| | | BASE/KICKPLATE OPTIONS <input type="checkbox"/> Kick plate same finish as Casing (0) <input type="checkbox"/> Black Painted Kick plate* (K) <input type="checkbox"/> No Base - Field Supplied (N) | |

| | |
|-----------------|---|
| Project: _____ | Submittal Date: _____ |
| Location: _____ | Product Code BUC-TE-_-_-_-_- <div style="text-align: right;">Page</div> |

Basic Utility Compartment (BUC-TLE) Smart Submittal for QLCI Terminals

Standard BUC-TLE

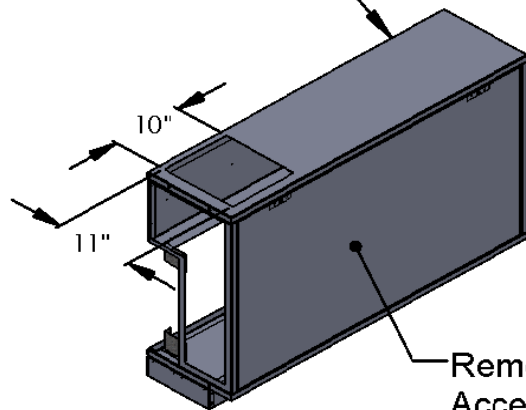

BUC-TLE-S

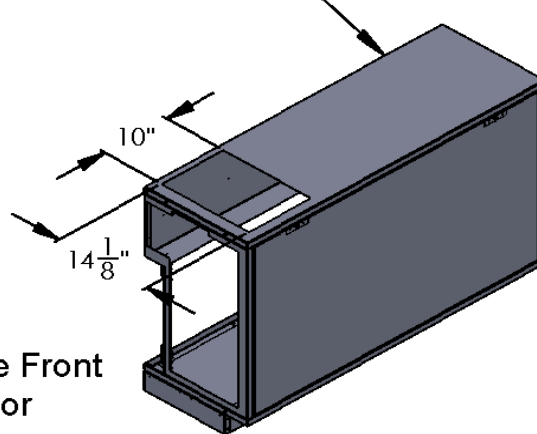

Removable Front
Access Door

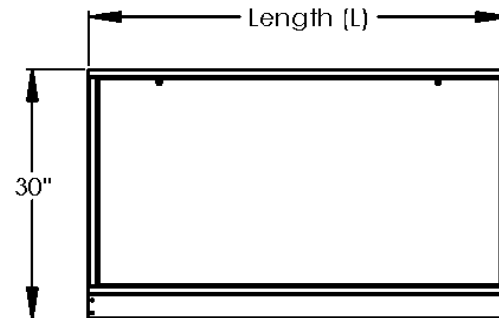
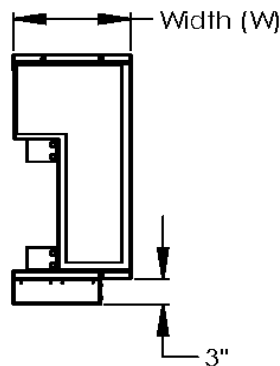

Tags: QTY:

Special
Notes

SPECIFICATIONS

- Cabinets constructed of 16ga steel and finished with powdercoat paint
- Both ends notched for pipework passage, top left entry
- Removable access door for access to piping and ductwork feeding adjacent QLCI terminals

***Indicates an added cost item.**

- Additional lead time may be required
- Contact Carson Solutions for more information
- ***Custom sizes available***

LENGTH (L)

- ☐ Size 18" ☐ Size 36"
☐ Size 24" ☐ Size 42"
☐ Size 30" ☐ Size 48"

DEPTH (W)

- ☐ 13 1/2" (R)
☐ 16 5/8" (S)

REAR HEATER (Not Available)

- ☐ No Rear Heater (as shown above) (0)

CABINET FINISH

- ☐ White (1) ☐ Gray (3) ☐ NLA (5) ☐ Other* (PX - Must Specify)
☐ NLA (2) ☐ Dark Gray (4) ☐ Ivory (6)

BASE/KICKPLATE OPTIONS

- ☐ Kick plate same finish as Casing (0)
☐ Black Painted Kick plate* (K)
☐ No Base - Field Supplied (N)

Project:

Submittal Date:

Location:

Product Code BUC-TLE- - - - -

Page

Basic Utility Compartment (BUC-TRE) Smart Submittal for QLCI Terminals

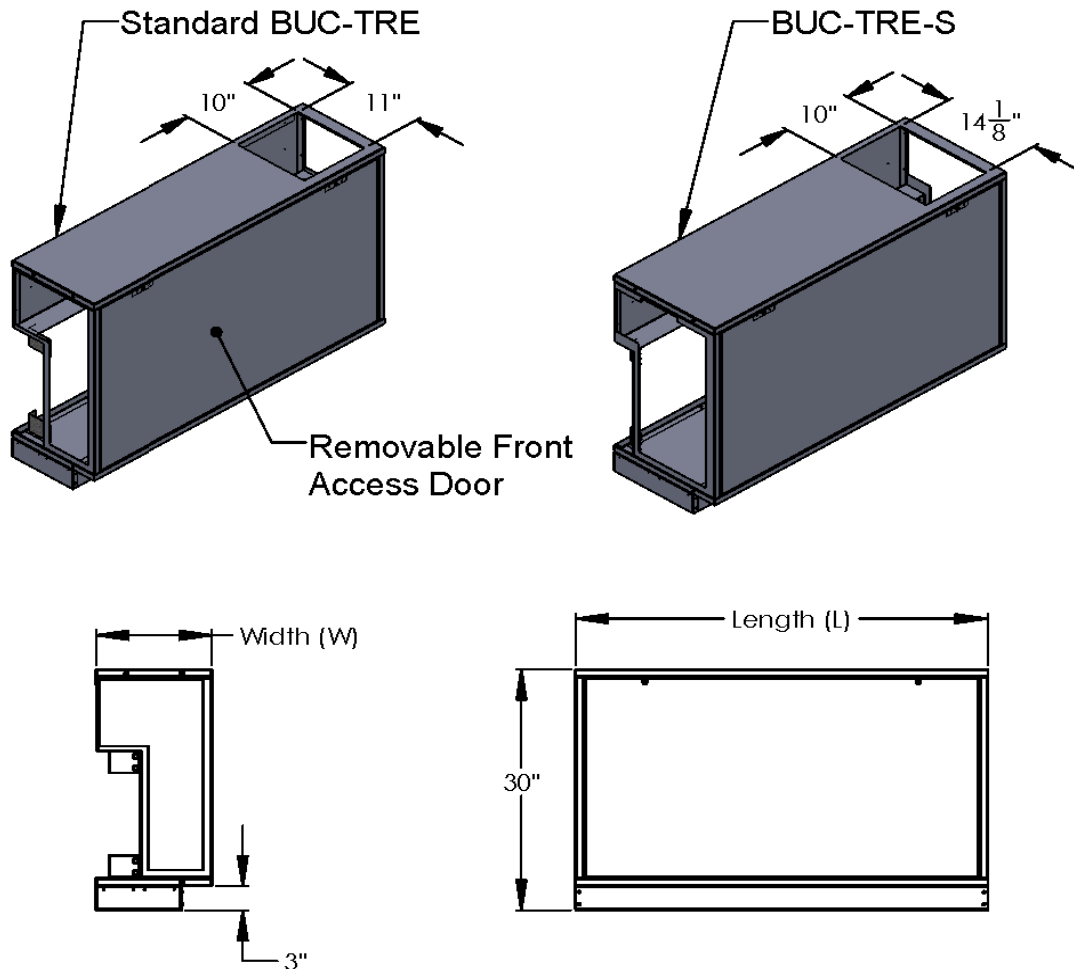

Tags: QTY:

Special Notes

SPECIFICATIONS

- Cabinets constructed of 16ga steel and finished with powdercoat paint
- Both ends notched for pipework passage, top right entry
- Removable access door for access to piping and ductwork feeding adjacent QLCI terminals

*Indicates an added cost item.

- Additional lead time may be required
- Contact Carson Solutions for more information
- ***Custom sizes available***

LENGTH (L)

- ☐ Size 18" ☐ Size 36"
☐ Size 24" ☐ Size 42"
☐ Size 30" ☐ Size 48"

DEPTH (W)

- ☐ 13½" (R)
☐ 16⅝" (S)

REAR HEATER (Not Available)

- ☐ No Rear Heater (as shown above) (0)

CABINET FINISH

- ☐ White (1) ☐ Gray (3) ☐ NLA (5) ☐ Other* (PX - Must Specify)
☐ NLA (2) ☐ Dark Gray (4) ☐ Ivory (6)

BASE/KICKPLATE OPTIONS

- ☐ Kick plate same finish as Casing (0)
☐ Black Painted Kick plate* (K)
☐ No Base - Field Supplied (N)

Project: _____

Submittal Date: _____

Location: _____

Product Code BUC-TRE-_-_-_-_-

Page

Basic Utility Compartment (BUC-L) Smart Submittal for QLCI Terminals

Standard BUC-L

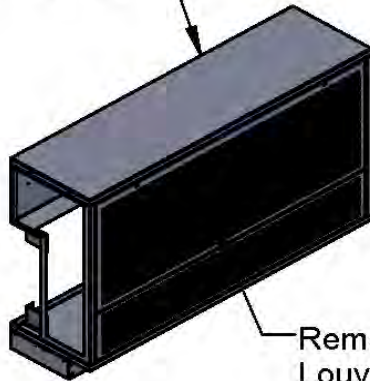

Removable Front
Louvered Access
Door

Removable Rear
Heater Top Panel
For BUC-L-S-H

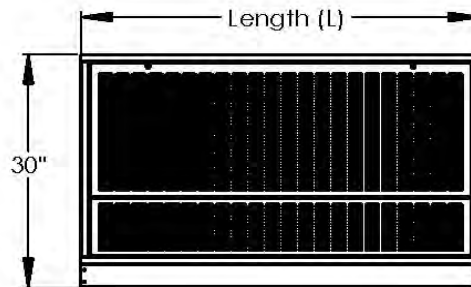
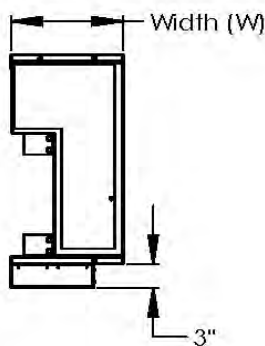
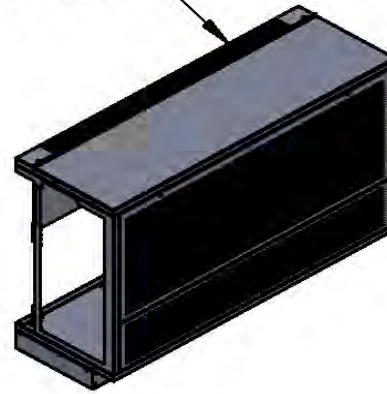

Tags: QTY:

Special Notes

SPECIFICATIONS

- Cabinets constructed of 16ga steel and finished with powdercoat paint
- Both ends notched for pipework passage
- Removable access door for access to piping and ductwork feeding adjacent QLCI terminals

*Indicates an added cost item.

- Additional lead time may be required
- Contact Carson Solutions for more information
- ***Custom sizes available***

LENGTH (L)

- ☐ Size 12" ☐ Size 30" ☐ Size 48"
☐ Size 18" ☐ Size 36"
☐ Size 24" ☐ Size 42"

DEPTH (W)

- ☐ 13½" (R)
☐ 16⅝"* (S)

REAR HEATER

- ☐ No Rear Heater (as shown above) (0)
☐ Rear Heater Casing* (Requires 16⅝" Depth Cabinet) (H)

CABINET FINISH

- ☐ White (1) ☐ Gray (3) ☐ NLA (5) ☐ Other* (PX - Must Specify)
☐ NLA (2) ☐ Dark Gray (4) ☐ Ivory (6)

BASE/KICKPLATE OPTIONS

- ☐ Kick plate same finish as Casing (0)
☐ Black Painted Kick plate* (K)
☐ No Base - Field Supplied (N)

Project:

Submittal Date:

Location:

Product Code BUC-L- - - - -

Page

Basic Utility Compartment (BUC-L-TE) Smart Submittal for QLCI Terminals

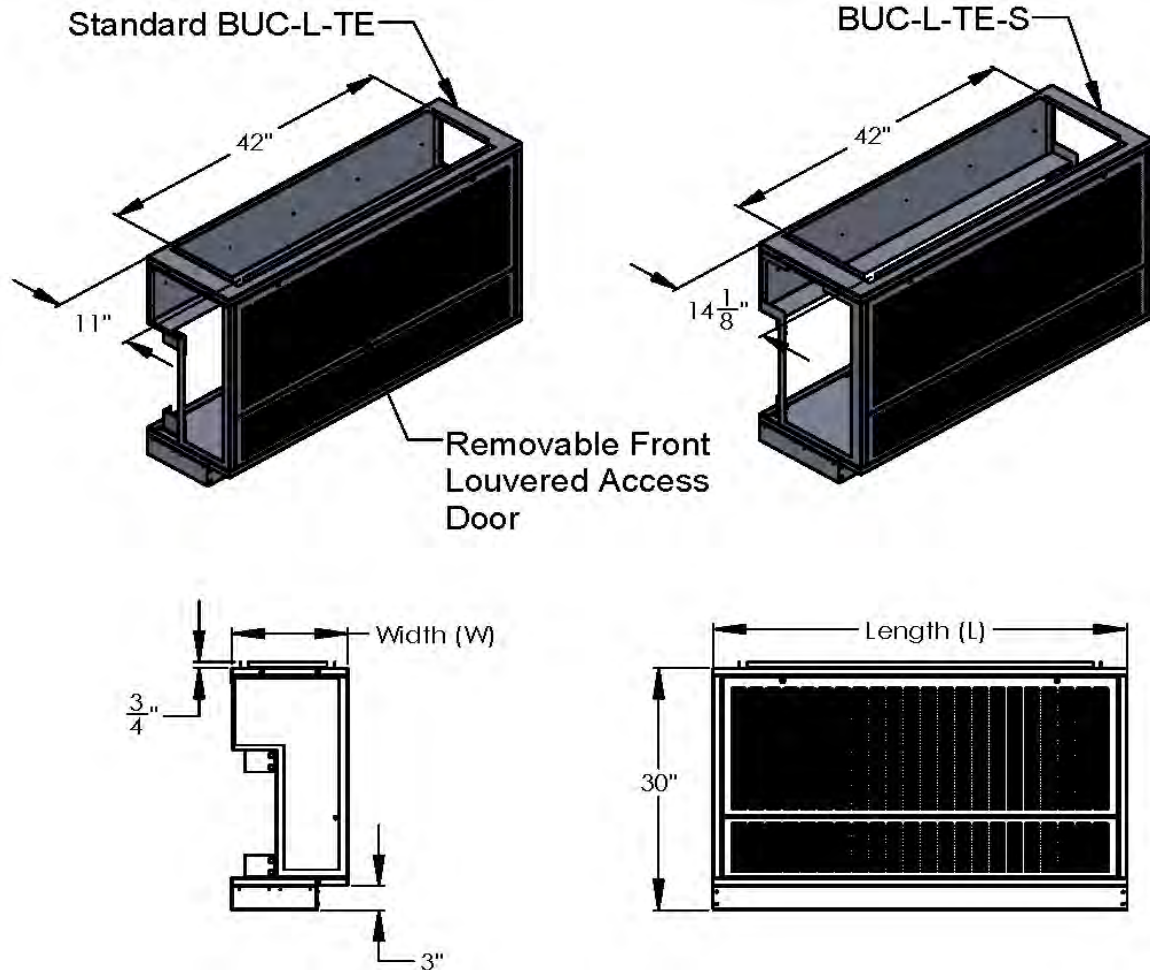

| | | | |
|---|-------------|--|--|
| Tags: | QTY: | LENGTH (L) <input type="checkbox"/> Size 18" <input type="checkbox"/> Size 36" <input type="checkbox"/> Size 24" <input type="checkbox"/> Size 42" <input type="checkbox"/> Size 30" <input type="checkbox"/> Size 48" | |
| Special Notes | | | |
| SPECIFICATIONS -Cabinets constructed of 16ga steel and finished with powdercoat paint -Both ends notched for pipework passage, top entry -Removable access door for access to piping and ductwork feeding adjacent QLCI terminals | | DEPTH (W) <input type="checkbox"/> 13 1/2" (R) <input type="checkbox"/> 16 5/8" (S) | |
| *Indicates an added cost item. -Additional lead time may be required -Contact Carson Solutions for more information ***Custom sizes available*** | | REAR HEATER (Not Available) <input type="checkbox"/> No Rear Heater (as shown above) (0) | |
| | | CABINET FINISH <input type="checkbox"/> White (1) <input type="checkbox"/> Gray (3) <input type="checkbox"/> NLA (5) <input type="checkbox"/> Other* (PX - Must Specify) <input type="checkbox"/> NLA (2) <input type="checkbox"/> Dark Gray (4) <input type="checkbox"/> Ivory (6) | |
| | | BASE/KICKPLATE OPTIONS <input type="checkbox"/> Kick plate same finish as Casing (0) <input type="checkbox"/> Black Painted Kick plate* (K) <input type="checkbox"/> No Base - Field Supplied (N) | |
| Project: _____ | | Submittal Date: _____ | |
| Location: _____ | | Product Code BUC-L-TE- - - - - Page | |

Basic Utility Compartment (BUC-L-TLE) Smart Submittal for QLCI Terminals

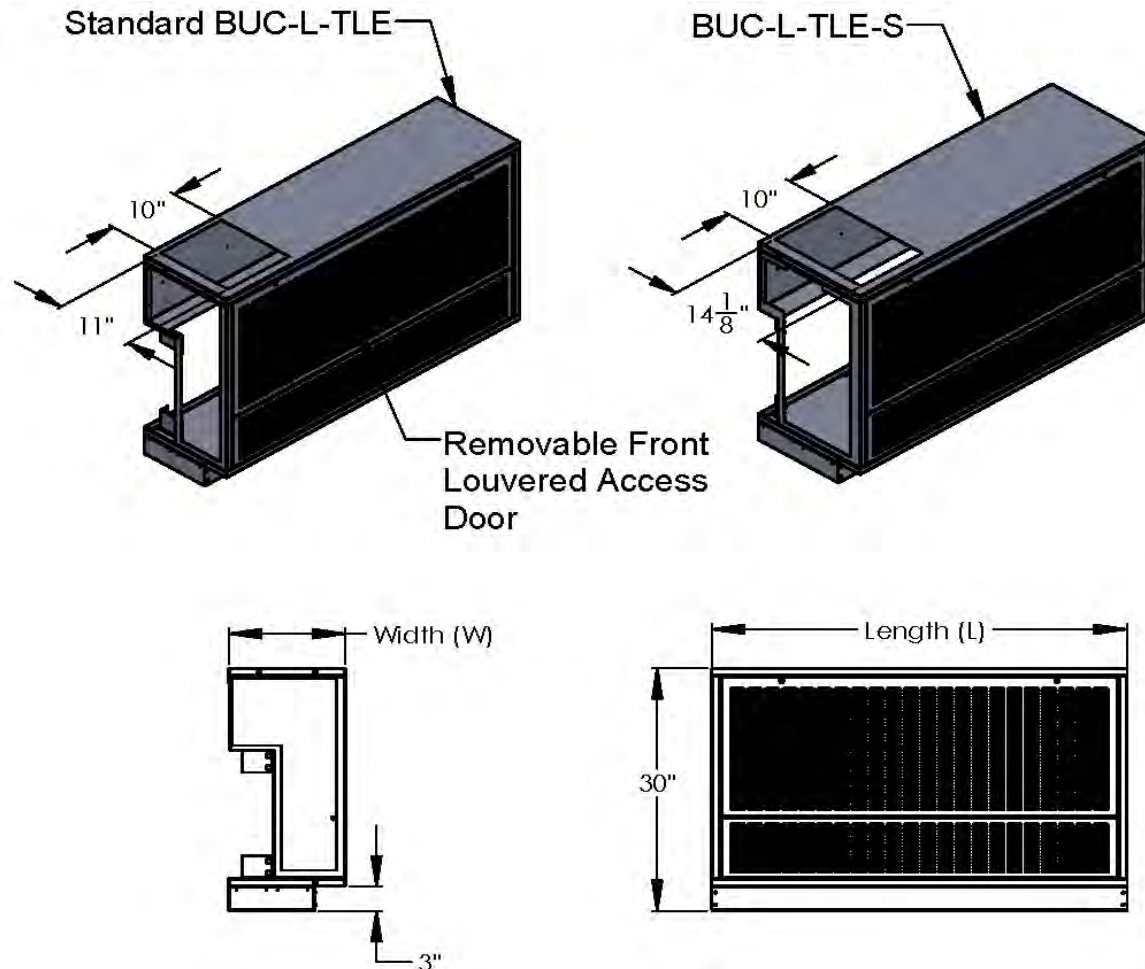

| | | | |
|--|--|--|--|
| Tags: | | QTY: | |
| | | | |
| Special Notes | | | |
| SPECIFICATIONS | | | |
| -Cabinets constructed of 16ga steel and finished with powdercoat paint -Both ends notched for pipework passage, top left entry -Removable access door for access to piping and ductwork feeding adjacent QLCI terminals | | | |
| *Indicates an added cost item. -Additional lead time may be required -Contact Carson Solutions for more information ***Custom sizes available*** | | | |
| LENGTH (L) <input type="checkbox"/> Size 18" <input type="checkbox"/> Size 24" <input type="checkbox"/> Size 30" <input type="checkbox"/> Size 36" <input type="checkbox"/> Size 42" <input type="checkbox"/> Size 48" | | DEPTH (W) <input type="checkbox"/> 13½" (R) <input type="checkbox"/> 16⅝" (S) | |
| REAR HEATER (Not Available) <input type="checkbox"/> No Rear Heater (as shown above) (0) | | | |
| CABINET FINISH <input type="checkbox"/> White (1) <input type="checkbox"/> Gray (3) <input type="checkbox"/> NLA (5) <input type="checkbox"/> Other* (PX - Must Specify) <input type="checkbox"/> NLA (2) <input type="checkbox"/> Dark Gray (4) <input type="checkbox"/> Ivory (6) | | | |
| BASE/KICKPLATE OPTIONS <input type="checkbox"/> Kick plate same finish as Casing (0) <input type="checkbox"/> Black Painted Kick plate* (K) <input type="checkbox"/> No Base - Field Supplied (N) | | | |

| | |
|-----------------|--------------------------------------|
| Project: _____ | Submittal Date: _____ |
| Location: _____ | Product Code BUC-L-TLE- - - - - Page |

Basic Utility Compartment (BUC-L-TRE) Smart Submittal for QLCI Terminals

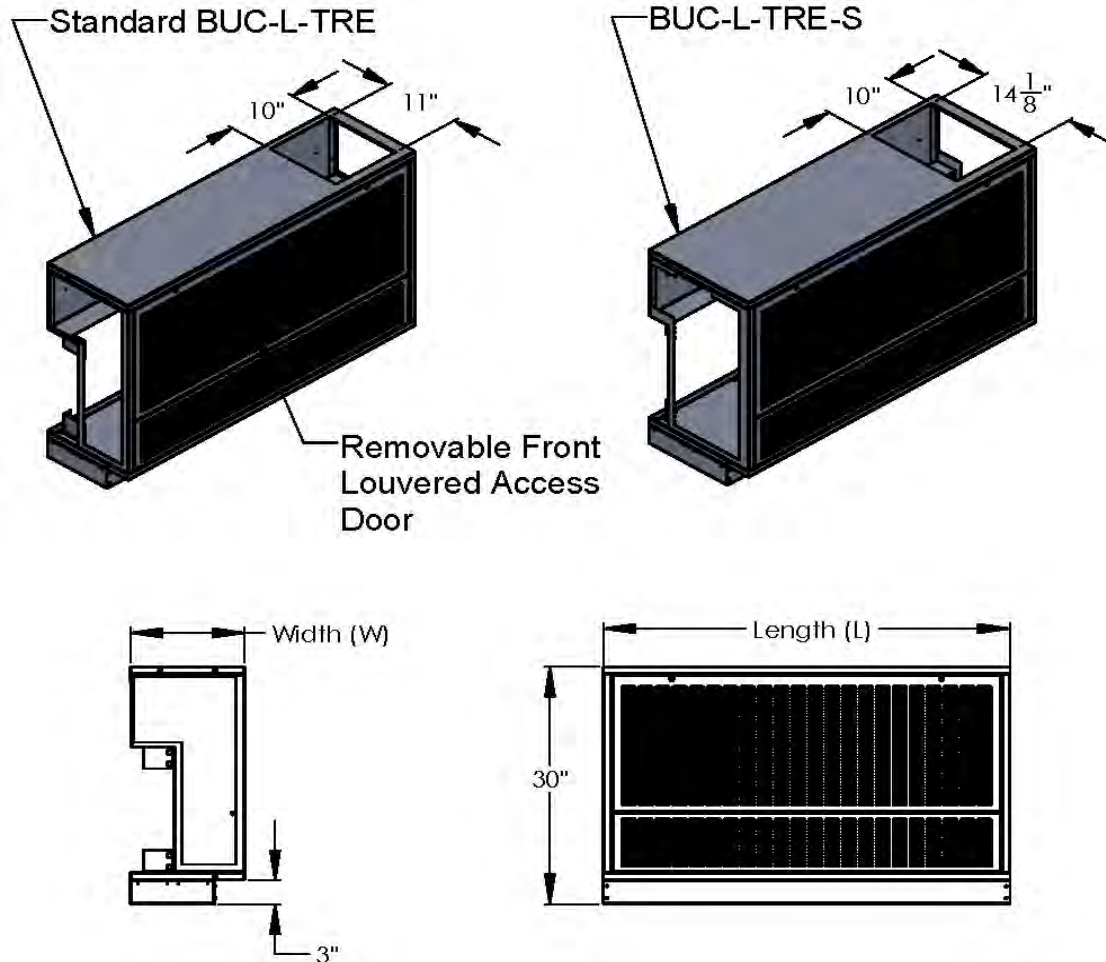

| | | | |
|---|-------------|--|--|
| Tags: | QTY: | LENGTH (L) <input type="checkbox"/> Size 18" <input type="checkbox"/> Size 36" <input type="checkbox"/> Size 24" <input type="checkbox"/> Size 42" <input type="checkbox"/> Size 30" <input type="checkbox"/> Size 48" | |
| Special Notes | | | |
| SPECIFICATIONS -Cabinets constructed of 16ga steel and finished with powdercoat paint -Both ends notched for pipework passage, top right entry -Removable access door for access to piping and ductwork feeding adjacent QLCI terminals *Indicates an added cost item. -Additional lead time may be required -Contact Carson Solutions for more information ***Custom sizes available*** | | | |
| | | DEPTH (W) <input type="checkbox"/> 13½" (R) <input type="checkbox"/> 16⅝" (S) | |
| | | REAR HEATER (Not Available) <input type="checkbox"/> No Rear Heater (as shown above) (0) | |
| | | CABINET FINISH <input type="checkbox"/> White (1) <input type="checkbox"/> Gray (3) <input type="checkbox"/> NLA (5) <input type="checkbox"/> Other* (PX - Must Specify) <input type="checkbox"/> NLA (2) <input type="checkbox"/> Dark Gray (4) <input type="checkbox"/> Ivory (6) | |
| | | BASE/KICKPLATE OPTIONS <input type="checkbox"/> Kick plate same finish as Casing (0) <input type="checkbox"/> Black Painted Kick plate* (K) <input type="checkbox"/> No Base - Field Supplied (N) | |

| | | |
|-----------------|-----------------------------------|-----------------------|
| Project: _____ | | Submittal Date: _____ |
| Location: _____ | Product Code BUC-L-TRE- _ _ _ _ _ | Page |

Basic Corner Unit (BCU) Smart Submittal for QLCI Terminals

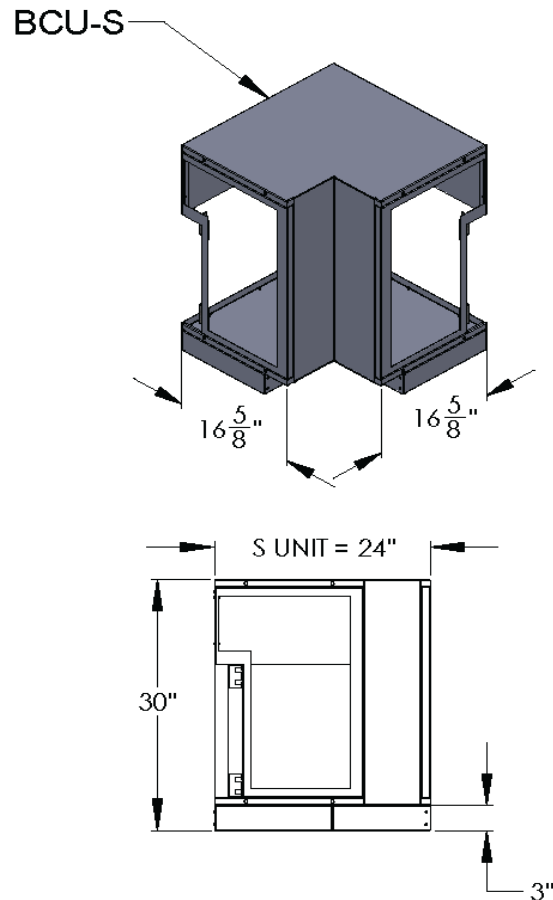
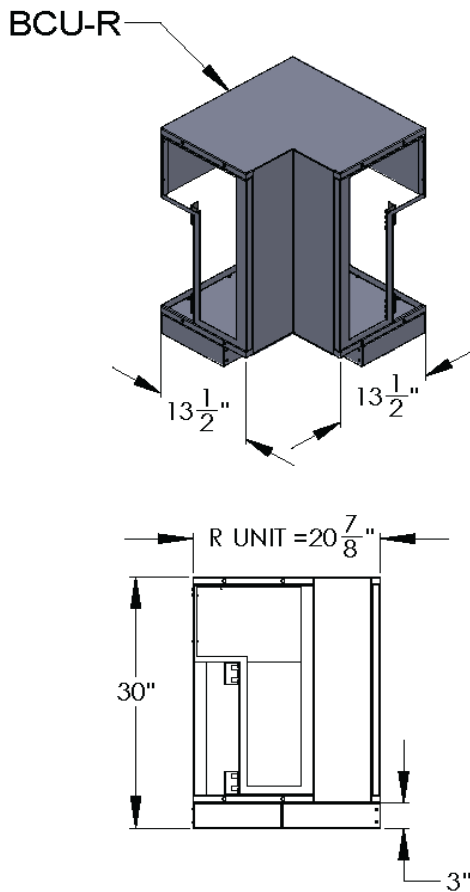

Tags: QTY:

Special Notes

SPECIFICATIONS

-Cabinets constructed of 16ga steel and finished with powdercoat paint
 -Both ends notched for pipework passage, side entry
 -Removable access door for access to piping and ductwork feeding adjacent QLCI terminals

***Indicates an added cost item.**

-Additional lead time may be required
 -Contact Carson Solutions for more information
 Custom sizes available

DEPTH (W)

- ☒ 13 1/2" (R)
☐ 16 5/8" (S)

REAR HEATER (Not Available)

- ☒ No Rear Heater (as shown above) (0)

CABINET FINISH

- ☐ White (1) ☐ Gray (3) ☐ NLA (5) ☐ Other* (PX - Must Specify)
☒ NLA (2) ☐ Dark Gray (4) ☐ Ivory (6)

BASE/KICKPLATE OPTIONS

- ☐ Kick plate same finish as Casing (0)
☐ Black Painted Kick plate* (K)
☒ No Base - Field Supplied (N)

Project:

Submittal Date:

Location:

Product Code BCU-R-0-N-2

Page

Basic Corner Unit (BCU-TE) Smart Submittal for QLCI Terminals

BCU-TE-R

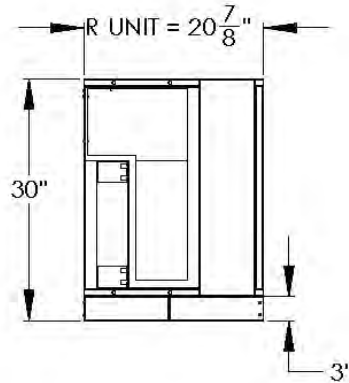
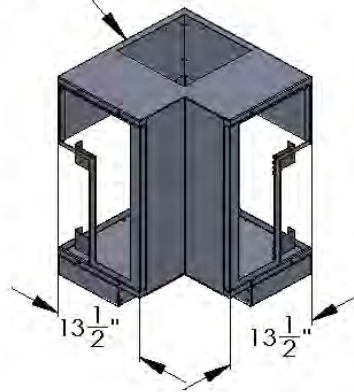

BCU-TE-S

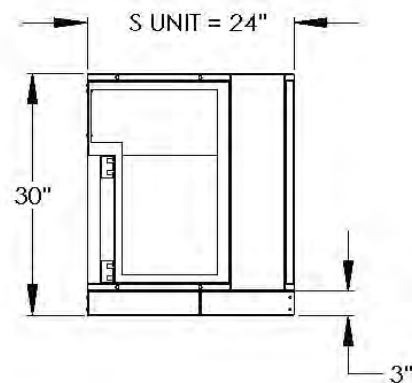
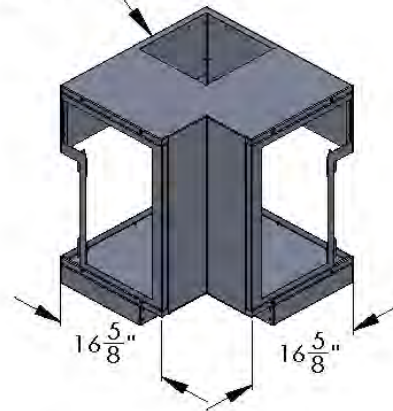

Tags: QTY:

Special Notes

SPECIFICATIONS

- Cabinets constructed of 16ga steel and finished with powdercoat paint
- Both ends notched for pipework passage, top entry
- Removable access door for access to piping and ductwork feeding adjacent QLCI terminals

***Indicates an added cost item.**

- Additional lead time may be required
- Contact Carson Solutions for more information
- ***Custom sizes available***

DEPTH (W)

- ☒ 13 1/2" (R)
- ☐ 16 5/8" (S)

REAR HEATER (Not Available)

- ☒ No Rear Heater (as shown above) (0)

CABINET FINISH

- ☒ White (1)
- ☐ Gray (3)
- ☐ NLA (5)
- ☐ Other* (PX - Must Specify)
- ☐ NLA (2)
- ☐ Dark Gray (4)
- ☐ Ivory (6)

BASE/KICKPLATE OPTIONS

- ☐ Kick plate same finish as Casing (0)
- ☐ Black Painted Kick plate* (K)
- ☒ No Base - Field Supplied (N)

Project:

Submittal Date:

Location:

Product Code BCU-TE-R-0-N-1

Page

Vertical Duct Cover 2-Sided (VDC2-R) Smart Submittal for QLCI Terminals

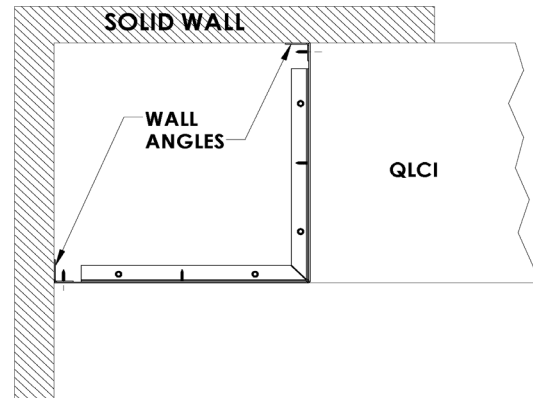
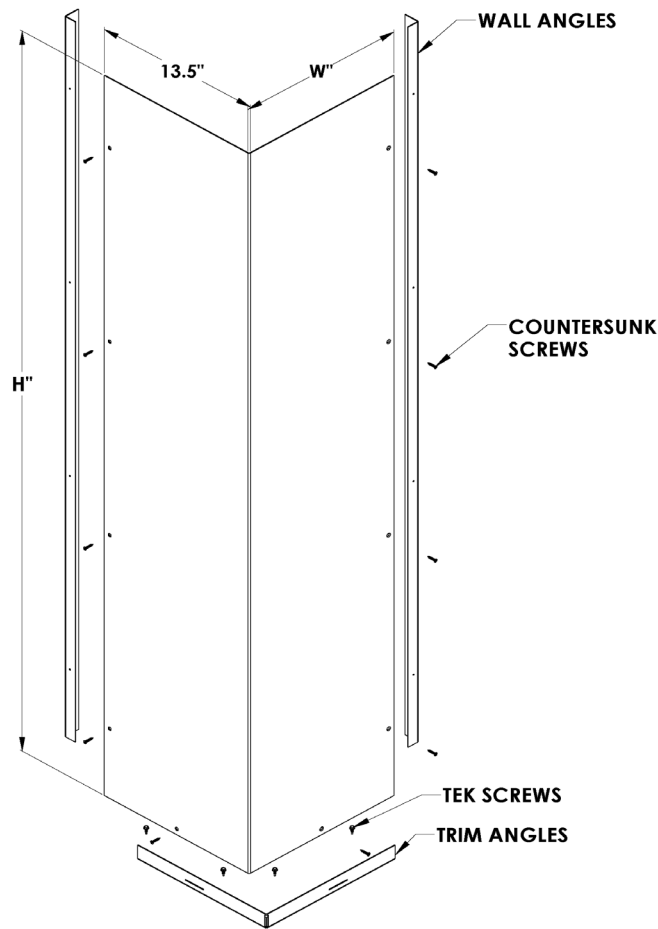

- COVER TO BE FIELD MOUNTED (BY OTHERS) USING WALL MOUNTED ANGLES
- WALL MOUNTING ANGLES TO BE INSTALLED (BY OTHERS)
- PAINTED COUNTERSUNK SCREWS ARE PROVIDED
- TRIM ANGLES TO BE SECURED (BY OTHERS) TO TOP OF QLCI CABINETS WITH SUPPLIED TEK SCREWS

Tags: QTY:

Special Notes

SPECIFICATIONS

- Covers constructed of 16ga steel and finished with powdercoat paint
- Includes wall angles with countersunk screws
- Includes angle plates to be mounted on top of the QLCI
- Cover to be field mounted (by others)

***Indicates an added cost item.**

- Additional lead time may be required
- Contact Carson Solutions for more information
- ***Custom sizes available***

HEIGHT (H)

L = "

Notes:

1. Any duct covers over 110" will be made into two separate covers*
2. Standards heights are 54" up to 96"

WIDTH (W)

- ☐ 13½" (R) for LE, RE, LEN, REN, LX, RX, LXN, RXN
- ☐ 16" (V) for LEX, REX, LXX, RXX, LZS, RZS
- ☐ 18" (T)
- ☐ 24" (Y)
- ☐ 30" (X)

CABINET FINISH

- ☐ White (1) ☐ Gray (3) ☐ NLA (5) ☐ Other*
- ☐ NLA (2) ☐ Dark Gray (4) ☐ Ivory (6)

Project:

Submittal Date:

Location:

Product Code VDC2-R-__

Page

Vertical Duct Cover 2-Sided (VDC2-S) Smart Submittal for QLCI Terminals

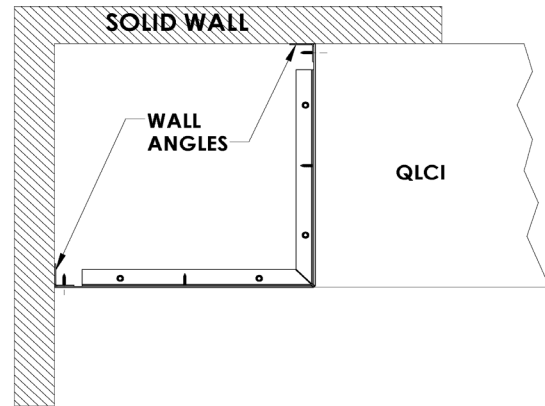
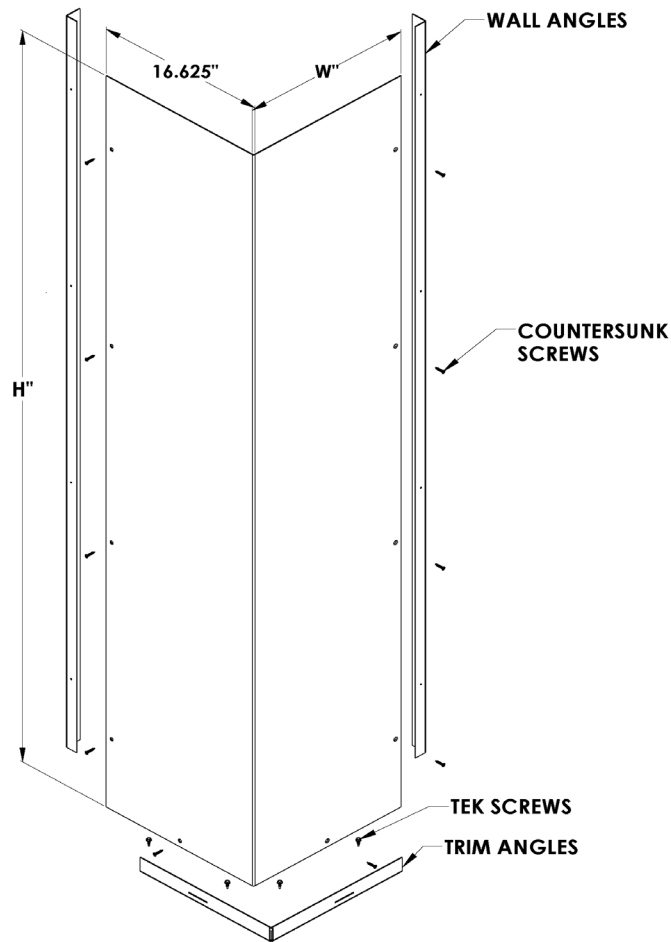

- COVER TO BE FIELD MOUNTED (BY OTHERS)
USING WALL MOUNTED ANGLES
- WALL MOUNTING ANGLES TO BE INSTALLED (BY OTHERS)
- PAINTED COUNTERSUNK SCREWS ARE PROVIDED
- TRIM ANGLES TO BE SECURED (BY OTHERS) TO
TOP OF QLCI CABINETS WITH SUPPLIED TEK SCREWS

| | |
|--|------|
| Tags: | QTY: |
| | |
| Special Notes | |
| SPECIFICATIONS | |
| -Covers constructed of 16ga steel and finished with powdercoat paint -Includes wall angles with countersunk screws -Includes angle plates to be mounted on top of the QLCI -Cover to be field mounted (by others) | |
| *Indicates an added cost item. -Additional lead time may be required -Contact Carson Solutions for more information ***Custom sizes available*** | |

HEIGHT (H)

L = "

Notes:

- Any duct covers over 110" will be made into two separate covers*
- Standards heights are 54" up to 96"

WIDTH (W)

- ☐ 13½" (R) for LE, RE, LEN, REN, LX, RX, LXN, RXN
- ☐ 16" (V) for LEX, REX, LXX, RXX, LZS, RZS
- ☐ 18" (T)
- ☐ 24" (Y)
- ☐ 30" (X)

CABINET FINISH

- | | | | |
|------------------------------------|--|------------------------------------|---------------------------------|
| <input type="checkbox"/> White (1) | <input type="checkbox"/> Gray (3) | <input type="checkbox"/> NLA (5) | <input type="checkbox"/> Other* |
| <input type="checkbox"/> NLA (2) | <input type="checkbox"/> Dark Gray (4) | <input type="checkbox"/> Ivory (6) | |

Project: _____

Submittal Date: _____

Location: _____

Product Code VDC2-S-__ _

Page

Vertical Duct Cover Corner 3-Sided (VDC3C-R) Smart Submittal for QLCI Terminals

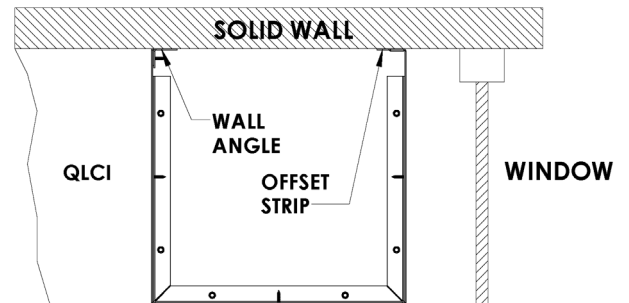
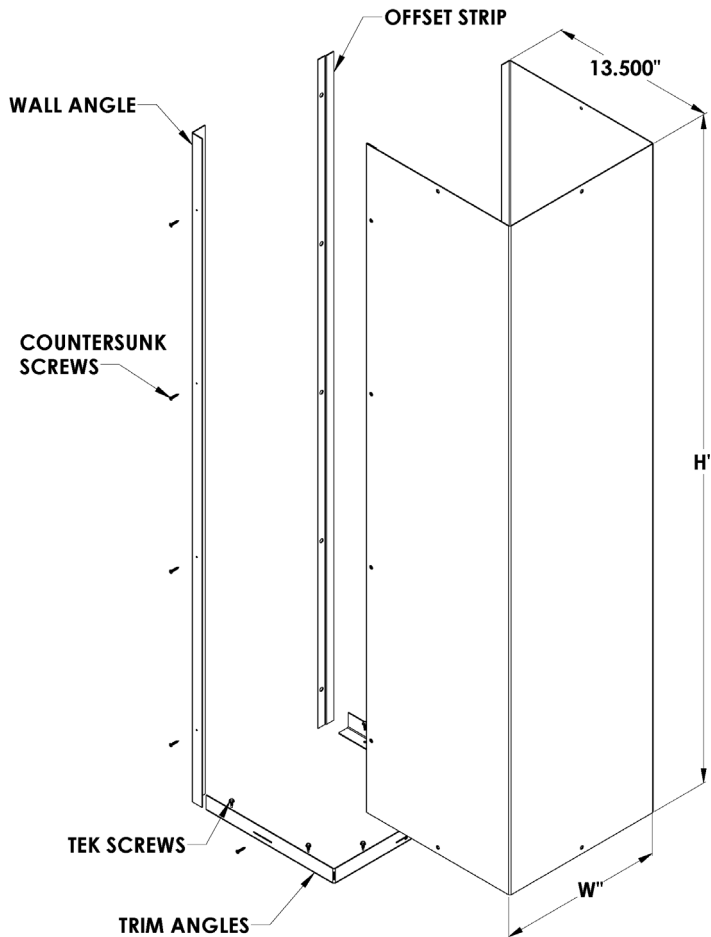

- COVER TO BE FIELD MOUNTED (BY OTHERS) USING WALL MOUNTED ANGLES
- WALL MOUNTING ANGLE AND OFFSET STRIP TO BE INSTALLED (BY OTHERS)
- PAINTED COUNTERSUNK SCREWS ARE PROVIDED
- TRIM ANGLES TO BE SECURED (BY OTHERS) TO TOP OF QLCI CABINETS WITH SUPPLIED TEK SCREWS

| | |
|--|-------------|
| Tags: | QTY: |
| | |
| Special Notes | |
| SPECIFICATIONS | |
| -Covers constructed of 16ga steel and finished with powdercoat paint | |
| -Includes wall angle and offset strip with countersunk screws | |
| -Includes angle plates to be mounted on top of the QLCI | |
| -Cover to be field mounted (by others) | |
| *Indicates an added cost item. | |
| -Additional lead time may be required | |
| -Contact Carson Solutions for more information | |
| ***Custom sizes available*** | |

HEIGHT (H)

 L = "

Notes:

1. Any duct covers over 96" will be made into two separate covers*
2. Standards heights are 54" up to 96"

WIDTH (W)

- ☐ 13½" (R) LE, RE, LEN, REN, LX, RX, LXN, RXN
- ☐ 16" (V) LEX, REX, LXX, RXX, LZS, RZS
- ☐ 18" (T)
- ☐ 24" (Y) 3 piece construction
- ☐ 32" (X) 3 piece construction

CABINET FINISH

- | | | | |
|------------------------------------|--|------------------------------------|---------------------------------|
| <input type="checkbox"/> White (1) | <input type="checkbox"/> Gray (3) | <input type="checkbox"/> NLA (5) | <input type="checkbox"/> Other* |
| <input type="checkbox"/> NLA (2) | <input type="checkbox"/> Dark Gray (4) | <input type="checkbox"/> Ivory (6) | |

Project: _____

Submittal Date: _____

Location: _____

Product Code VDC3C-R-__

Page

Vertical Duct Cover Corner 3-Sided (VDC3C-S) Smart Submittal for QLCI Terminals

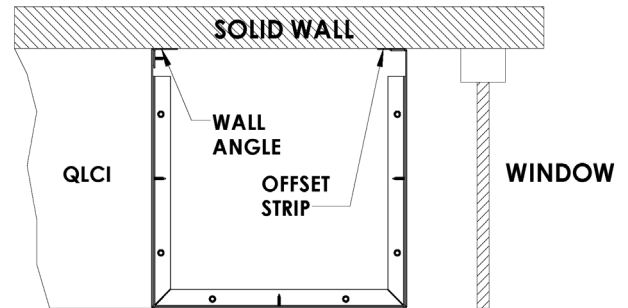
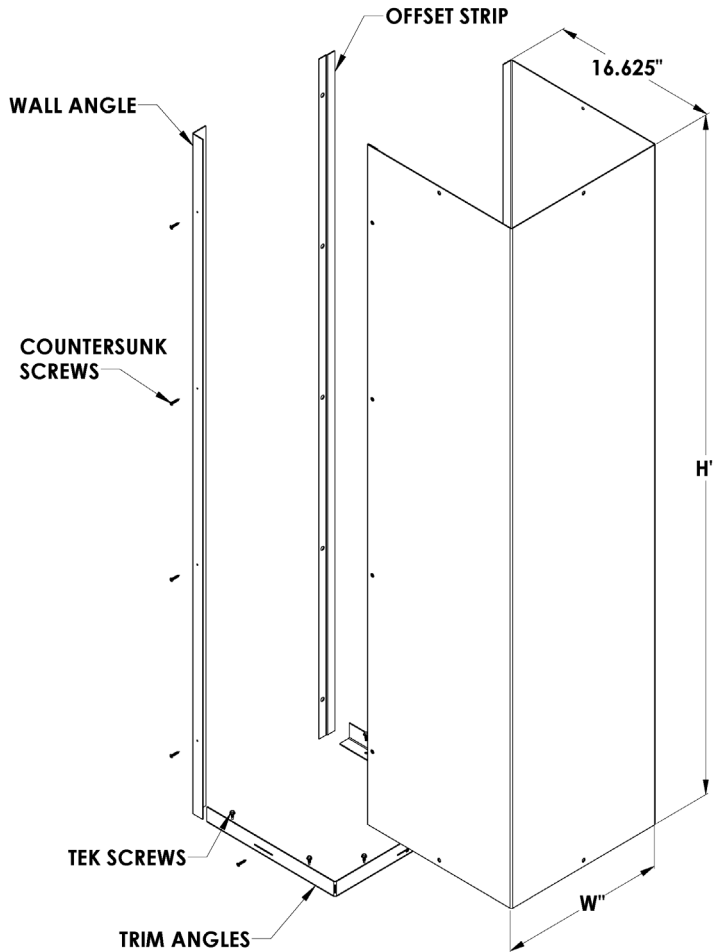

- COVER TO BE FIELD MOUNTED (BY OTHERS) USING WALL MOUNTED ANGLES
- WALL MOUNTING ANGLE AND OFFSET STRIP TO BE INSTALLED (BY OTHERS)
- PAINTED COUNTERSUNK SCREWS ARE PROVIDED
- TRIM ANGLES TO BE SECURED (BY OTHERS) TO TOP OF QLCI CABINETS WITH SUPPLIED TEK SCREWS

Tags: QTY:

Special Notes

SPECIFICATIONS

- Covers constructed of 16ga steel and finished with powdercoat paint
- Includes wall angle and offset strip with countersunk screws
- Includes angle plates to be mounted on top of the QLCI
- Cover to be field mounted (by others)

***Indicates an added cost item.**

- Additional lead time may be required
- Contact Carson Solutions for more information
- ***Custom sizes available***

HEIGHT (H)

L = "

Notes:

1. Any duct covers over 96" will be made into two separate covers*
2. Standards heights are 54" up to 96"

WIDTH (W)

- ☐ 13½" (R) LE, RE, LEN, REN, LX, RX, LXN, RXN
- ☐ 16" (V) LEX, REX, LXX, RXX, LZS, RZS 3 piece construction
- ☐ 18" (T) 3 piece construction
- ☐ 24" (Y) 3 piece construction
- ☐ 32" (X) 3 piece construction

CABINET FINISH

- ☐ White (1)
- ☐ Gray (3)
- ☐ NLA (5)
- ☐ Other*
- ☐ NLA (2)
- ☐ Dark Gray (4)
- ☐ Ivory (6)

Project:

Submittal Date:

Location:

Product Code VDC3C-S-__

Page

Vertical Duct Cover Wall 3-Sided (VDC3W-R) Smart Submittal for QLCI Terminals

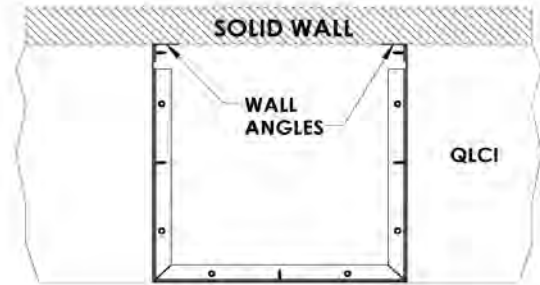
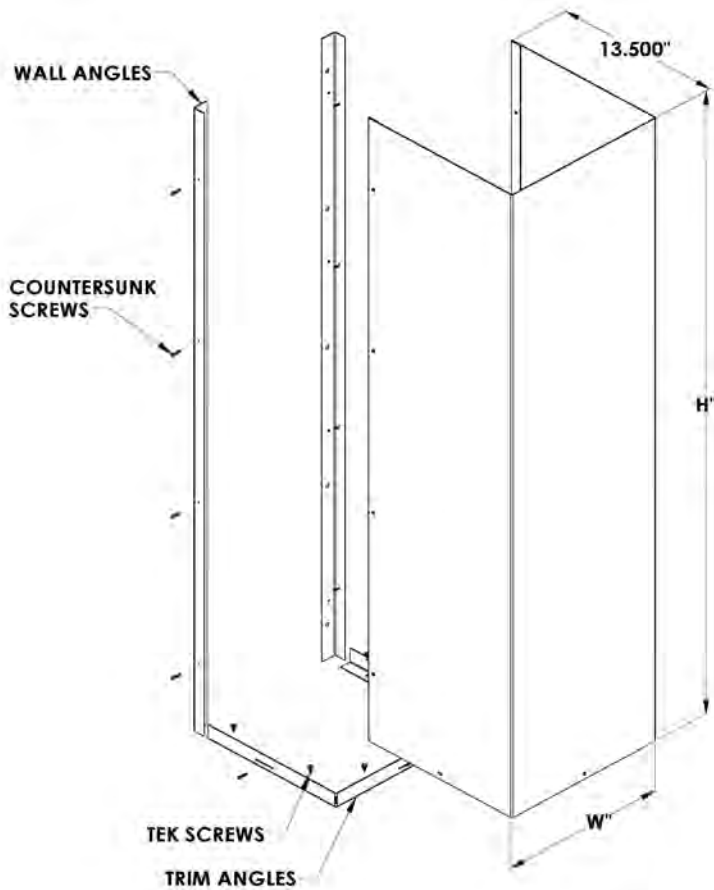

- COVER TO BE FIELD MOUNTED (BY OTHERS) USING WALL MOUNTED ANGLES
- WALL MOUNTING ANGLES TO BE INSTALLED (BY OTHERS)
- PAINTED COUNTERSUNK SCREWS ARE PROVIDED
- TRIM ANGLES TO BE SECURED (BY OTHERS) TO TOP OF QLCI CABINETS WITH SUPPLIED TEK SCREWS

| | |
|--|-------------|
| Tags: | QTY: |
| | |
| Special Notes | |
| SPECIFICATIONS | |
| -Covers constructed of 16ga steel and finished with powdercoat paint -Includes wall angles with countersunk screws -Includes angle plates to be mounted on top of the QLCI -Cover to be field mounted (by others) | |
| *Indicates an added cost item. -Additional lead time may be required -Contact Carson Solutions for more information ***Custom sizes available*** | |

HEIGHT (H)

 L = "

Notes:

1. Any duct covers over 96" will be made into two separate covers*
2. Standards heights are 54" up to 96"

DEPTH (W)

- ☐ 13½" (R) LE, RE, LEN, REN, LX, RX, LXN, RXN
- ☐ 16" (V) LEX, REX, LXX, RXX, LZS, RZS
- ☐ 18" (T)
- ☐ 24" (Y) 3 piece construction
- ☐ 32" (X) 3 piece construction

CABINET FINISH

- | | | | |
|------------------------------------|--|------------------------------------|---------------------------------|
| <input type="checkbox"/> White (1) | <input type="checkbox"/> Gray (3) | <input type="checkbox"/> NLA (5) | <input type="checkbox"/> Other* |
| <input type="checkbox"/> NLA (2) | <input type="checkbox"/> Dark Gray (4) | <input type="checkbox"/> Ivory (6) | |

| | | |
|-----------------|-------------------------|------------|
| Project: _____ | Submittal Date: _____ | |
| Location: _____ | Product Code VDC3W-R-__ | Page _____ |

Vertical Duct Cover Wall 3-Sided (VDC3W-S) Smart Submittal for QLCI Terminals

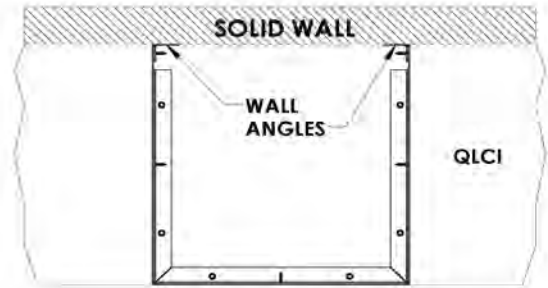
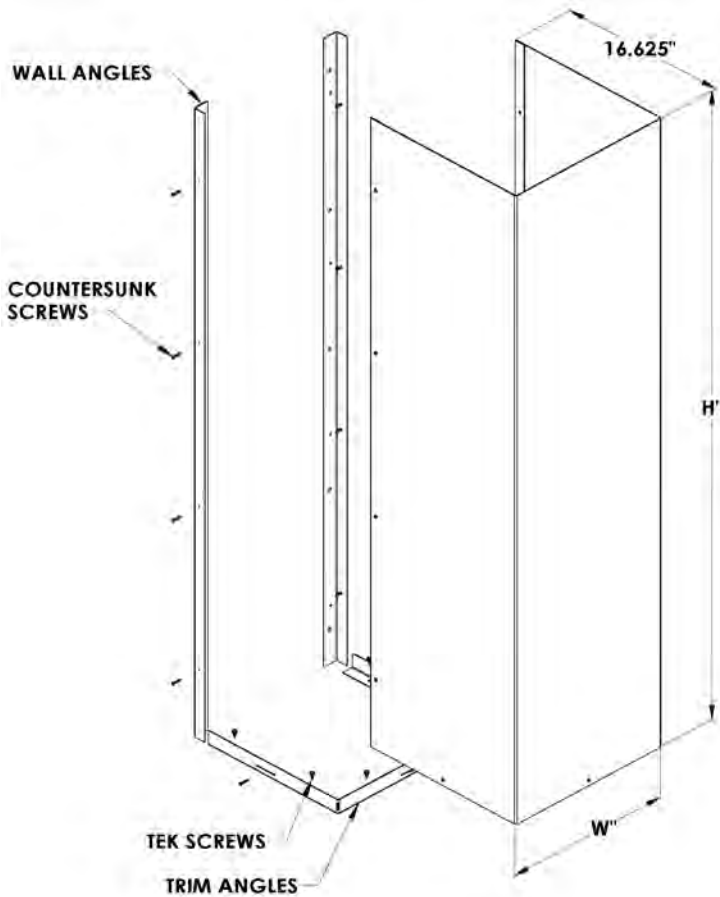

- COVER TO BE FIELD MOUNTED (BY OTHERS) USING WALL MOUNTED ANGLES
- WALL MOUNTING ANGLES TO BE INSTALLED (BY OTHERS)
- PAINTED COUNTERSUNK SCREWS ARE PROVIDED
- TRIM ANGLES TO BE SECURED (BY OTHERS) TO TOP OF QLCI CABINETS WITH SUPPLIED TEK SCREWS

| | |
|---|-------------|
| Tags: | QTY: |
| | |
| Special Notes | |
| SPECIFICATIONS -Covers constructed of 16ga steel and finished with powdercoat paint -Includes wall angles with countersunk screws -Includes angle plates to be mounted on top of the QLCI -Cover to be field mounted (by others) | |
| *Indicates an added cost item. -Additional lead time may be required -Contact Carson Solutions for more information ***Custom sizes available*** | |

HEIGHT (H)

 L = "

Notes:

1. Any duct covers over 96" will be made into two separate covers*
2. Standards heights are 54" up to 96"

DEPTH (W)

- ☐ 13½" (R) LE, RE, LEN, REN, LX, RX, LXN, RXN
- ☐ 16" (V) LEX, REX, LXX, RXX, LZS, RZS 3 piece construction
- ☐ 18" (T) 3 piece construction
- ☐ 24" (Y) 3 piece construction
- ☐ 32" (X) 3 piece construction

CABINET FINISH

- | | | | |
|------------------------------------|--|------------------------------------|---------------------------------|
| <input type="checkbox"/> White (1) | <input type="checkbox"/> Gray (3) | <input type="checkbox"/> NLA (5) | <input type="checkbox"/> Other* |
| <input type="checkbox"/> NLA (2) | <input type="checkbox"/> Dark Gray (4) | <input type="checkbox"/> Ivory (6) | |

| | | |
|-----------------|-------------------------|------------|
| Project: _____ | Submittal Date: _____ | |
| Location: _____ | Product Code VDC3W-S-__ | Page _____ |

Vertical Duct Cover 4-Sided (VDC4-R) Smart Submittal for QLCI Terminals

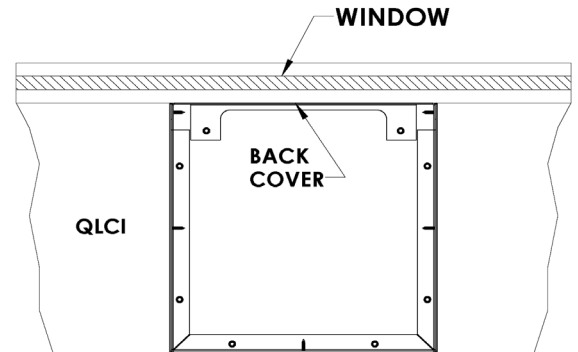
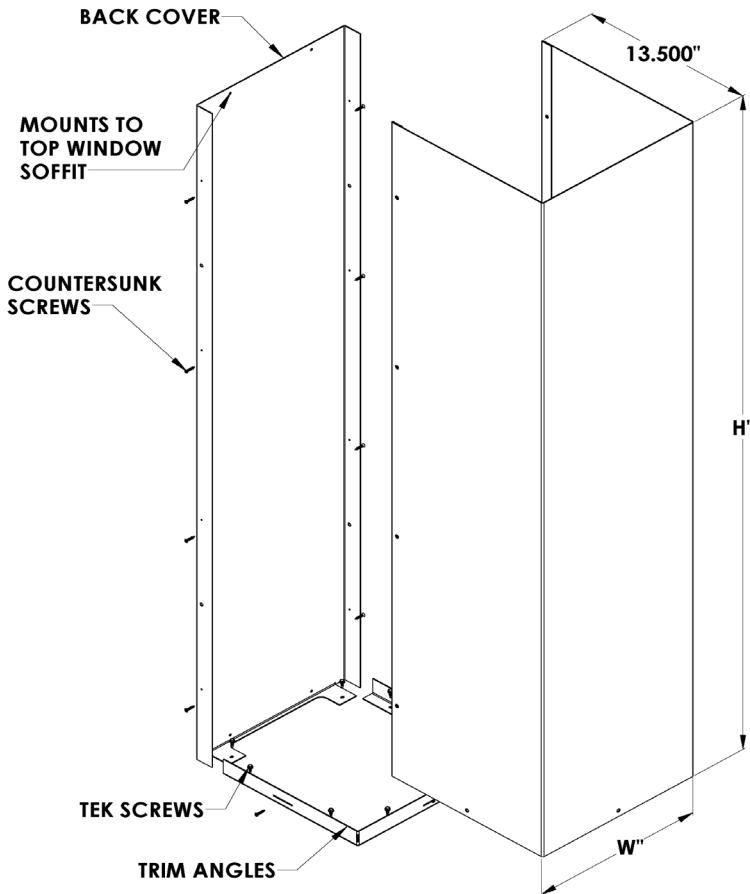

- COVER TO BE FIELD MOUNTED (BY OTHERS) USING WALL MOUNTED BACK COVER
- BACK COVER MOUNTS TO TOP SOFFIT (ABOVE WINDOW) AND TOP OF QLCI CABINET (BY OTHERS)
- PAINTED COUNTERSUNK SCREWS ARE PROVIDED
- TRIM ANGLES TO BE SECURED (BY OTHERS) TO TOP OF QLCI CABINETS WITH SUPPLIED TEK SCREWS

| | |
|---|-------------|
| Tags: | QTY: |
| | |
| Special Notes | |
| SPECIFICATIONS | |
| -Covers constructed of 16ga steel and finished with powdercoat paint -Includes back cover with countersunk screws -Includes angle plates to be mounted on top of the QLCI -Cover to be field mounted (by others) | |
| *Indicates an added cost item. -Additional lead time may be required -Contact Carson Solutions for more information ***Custom sizes available*** | |

HEIGHT (H)

 L = "

Notes:

1. Any duct covers over 96" will be made into two separate covers*
2. Standards heights are 54" up to 96"

WIDTH (W)

- ☐ 13½" (R) LE, RE, LEN, REN, LX, RX, LXN, RXN
- ☐ 16" (V) LEX, REX, LXX, RXX, LZS, RZS
- ☐ 18" (T)
- ☐ 24" (Y) 3 piece construction
- ☐ 32" (X) 4 piece construction

CABINET FINISH

- | | | | |
|------------------------------------|--|------------------------------------|---------------------------------|
| <input type="checkbox"/> White (1) | <input type="checkbox"/> Gray (3) | <input type="checkbox"/> NLA (5) | <input type="checkbox"/> Other* |
| <input type="checkbox"/> NLA (2) | <input type="checkbox"/> Dark Gray (4) | <input type="checkbox"/> Ivory (6) | |

| | | |
|-----------------|--------------------------|------------|
| Project: _____ | Submittal Date: _____ | |
| Location: _____ | Product Code VDC4-R-__ _ | Page _____ |

Vertical Duct Cover 4-Sided (VDC4-S) Smart Submittal for QLCI Terminals

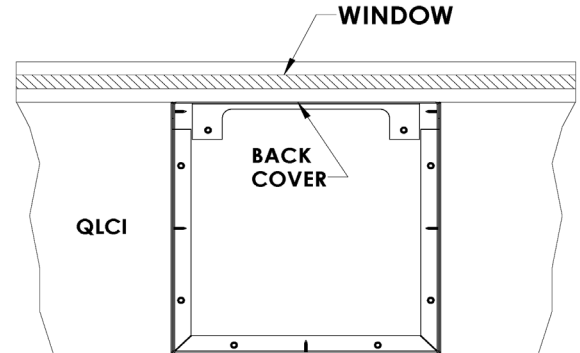
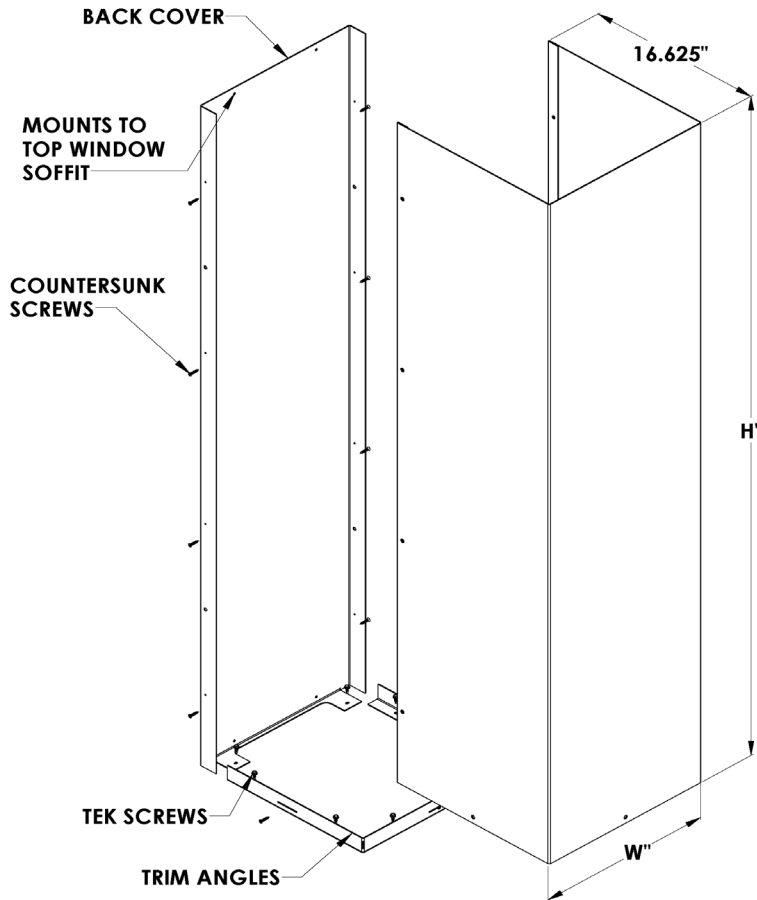

- COVER TO BE FIELD MOUNTED (BY OTHERS) USING WALL MOUNTED BACK COVER
- BACK COVER MOUNTS TO TOP SOFFIT (ABOVE WINDOW) AND TOP OF QLCI CABINET (BY OTHERS)
- PAINTED COUNTERSUNK SCREWS ARE PROVIDED
- TRIM ANGLES TO BE SECURED (BY OTHERS) TO TOP OF QLCI CABINETS WITH SUPPLIED TEK SCREWS

| | |
|---|-------------|
| Tags: | QTY: |
| | |
| Special Notes | |
| SPECIFICATIONS | |
| -Covers constructed of 16ga steel and finished with powdercoat paint -Includes back cover with countersunk screws -Includes angle plates to be mounted on top of the QLCI -Cover to be field mounted (by others) | |
| *Indicates an added cost item. -Additional lead time may be required -Contact Carson Solutions for more information ***Custom sizes available*** | |

HEIGHT (H)

 L = "

Notes:

1. Any duct covers over 96" will be made into two separate covers*
2. Standards heights are 54" up to 96"

WIDTH (W)

- ☐ 13½" (R) LE, RE, LEN, REN, LX, RX, LXN, RXN
- ☐ 16" (V) LEX, REX, LXX, RXX, LZS, RZS 4 piece construction
- ☐ 18" (T) 4 piece construction
- ☐ 24" (Y) 4 piece construction
- ☐ 32" (X) 4 piece construction

CABINET FINISH

- | | | | |
|------------------------------------|--|------------------------------------|---------------------------------|
| <input type="checkbox"/> White (1) | <input type="checkbox"/> Gray (3) | <input type="checkbox"/> NLA (5) | <input type="checkbox"/> Other* |
| <input type="checkbox"/> NLA (2) | <input type="checkbox"/> Dark Gray (4) | <input type="checkbox"/> Ivory (6) | |

| | | |
|-----------------|--------------------------|------------|
| Project: _____ | Submittal Date: _____ | |
| Location: _____ | Product Code VDC4-S-__ _ | Page _____ |

CARSON SOLUTIONS

HSS Series Specifications Stainless Steel Braided Hose

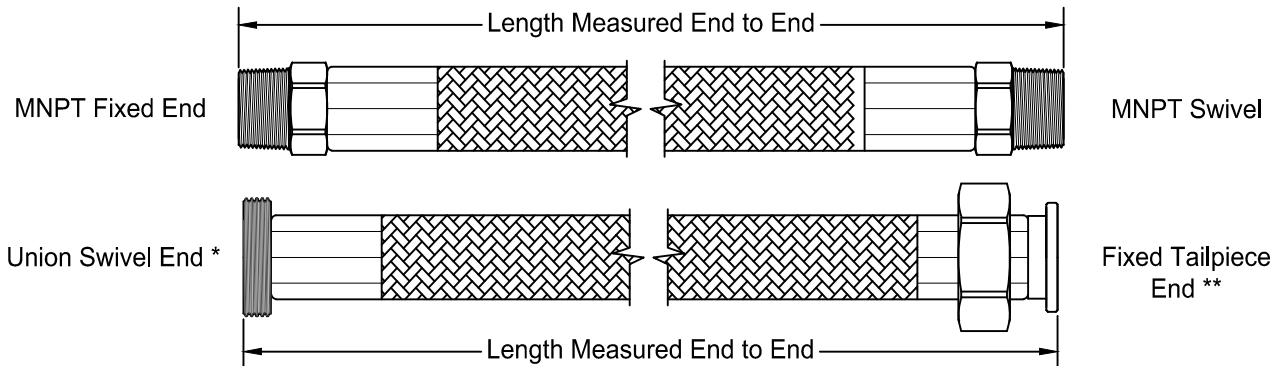

PRODUCT DESCRIPTION: The Model HSS is a stainless steel braided hose that is abrasion resistant. The HSS has a CPE inner tube with brass end connections and stainless steel ferrules for the ½" - 1" hose sizes, and an EPDM inner tube with stainless steel ferrules and plated steel end connections for the 1¼" - 2" hose sizes. The flexible hose eases installation and is designed to withstand high pressures and varying temperatures. The standard end connections are MNPT Fixed x MNPT Swivel. Other available end connection options are FNPT Swivel, Union Swivel *, and Fixed Tailpiece** connections; available for the ½", ¾", and 1" hose sizes. The Model HSS is BUY AMERICAN COMPLIANT.

* The Swivel Union comes standard with an EPDM O-ring, tailpiece, and union nut which must be specified at the time of order. The swivel union easily converts line connection types and offers line size reductions. The tailpieces are available in FNPT, MNPT, and Sweat ends.

** The Fixed Tailpiece hose end connection is designed to connect directly to union ended coil kit components (AFLB, AFLD, AU, CBV, IBU, or IVY). The tailpiece end eliminates multiple connections.

| PRODUCT SPECIFICATIONS | |
|------------------------|--|
| Tube | CPE (Chlorinated Polyethylene) for ½" - 1" sizes - SAE J1019 EPDM (Ethylene Propylene Diene Monomer) for 1¼" - 2" sizes - SAE 20R1-D1 |
| Reinforcement | 304L Stainless Steel braid cover meets UL-94 requirements |
| Ferrules | Type 304L stainless Steel ½" - 1" I.D. - Brass |
| End Fittings | 1¼" - 2" I.D. - Steel Plated -40°F to 257°F (-40°C to 125°C) |
| End Connections | NPT Male, NPT Male Swivel, NPT Female Swivel (½" - 1"), Swivel Union * (½" - 1"), Tailpiece ** (½" - 1") |
| Temperature | Meets UL-94 Requirements |
| Ratings | Fire Retardant Material (CPE) |

Specification information is provided to assist and is given without obligation or warranty. The Company reserves the right to make changes in design, materials, and/or specifications without notice.

| Size | Length | Working PSI | Bend Radius | ** Cv |
|------|--------------------|-------------|-------------|-------|
| ½" | 12, 18, 24, 30, 36 | 500 PSI | 5" | 7 |
| ¾" | 12, 18, 24, 30, 36 | 500 PSI | 7" | 20 |
| 1" | 12, 18, 24, 30, 36 | 500 PSI | 7" | 43 |
| 1¼" | 12, 18, 24, 30, 36 | 200 PSI | 12" | 76 |
| 1½" | 18, 24, 30, 36 | 200 PSI | 12" | 130 |
| 2" | 18, 24, 30, 36 | 200 PSI | 20" | 280 |

Length is measured End to End on all hose connection types.

** Cv listed in chart above is for a 24" length hose. The Cv is estimated and can vary according to installation.



HSS Series Options Stainless Steel Braided Hose

Fixed MNPT

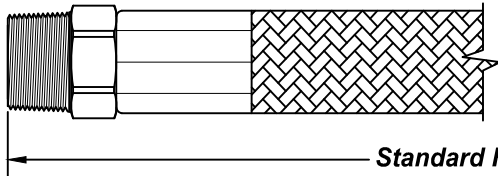

Swivel MNPT

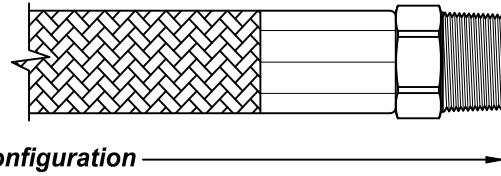

Standard Hose Configuration

Additional End Connections

Swivel FNPT

Available in 1/2", 3/4", & 1"

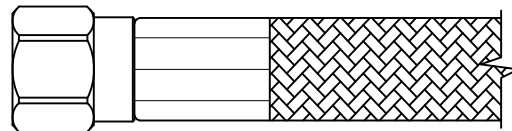

Swivel Union

Available in 1/2", 3/4", & 1"

The Swivel Union must have the tailpiece connection size and type specified at time of order. Tailpiece options include FPT, SWT, MPT, and a variety of reductions.

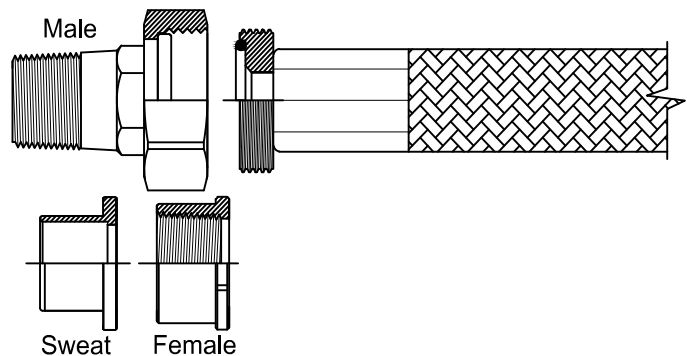

Fixed Tailpiece

Available in 1/2", 3/4", & 1"

The Fixed Tailpiece connects directly to PRO Hydronic Specialties' union ended products.

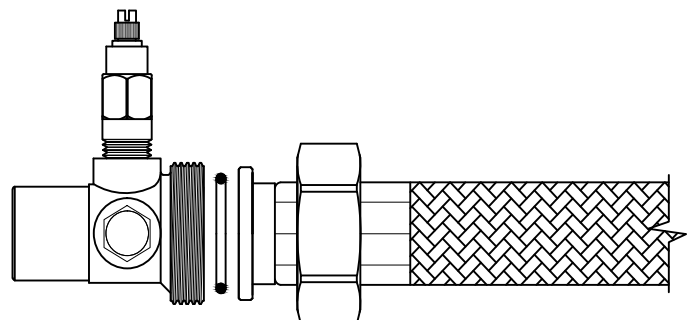

CARSON SOLUTIONS

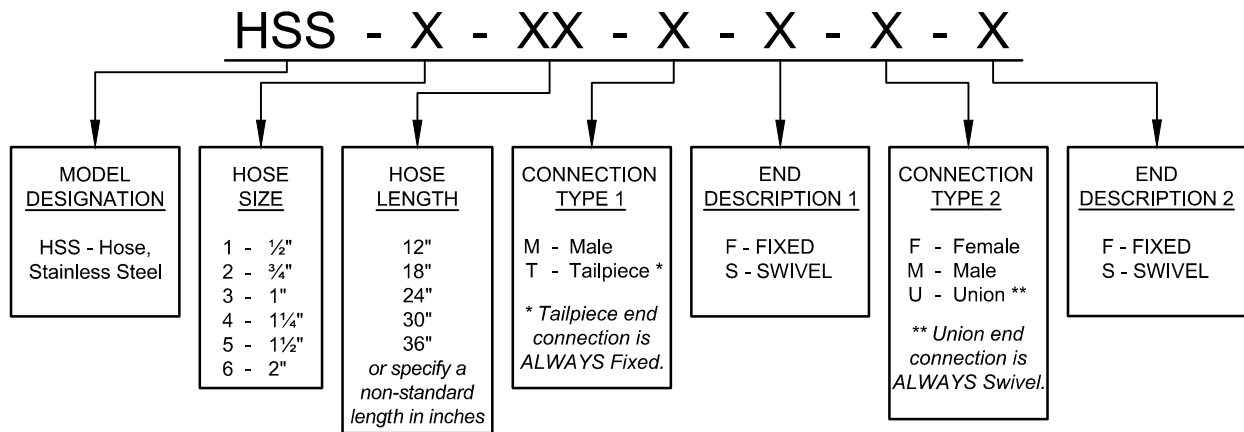
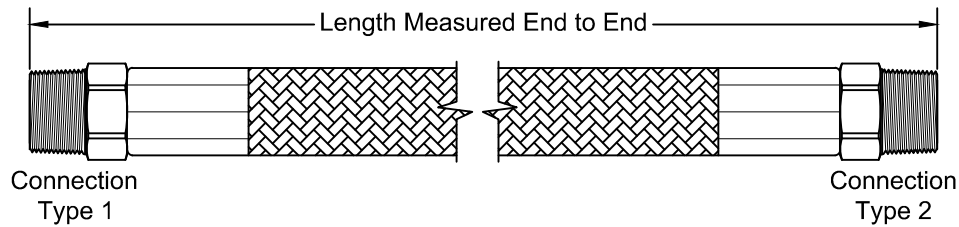

When ordering, at least one hose end connection must be a swivel.

| | | |
|---------------------------|-----------------|----------|
| JOB NAME: | REPRESENTATIVE: | |
| ENGINEER: | REF/PO#: | DATE: |
| CONTRACTOR: | SUBMITTED BY: | DATE: |
| PART # (See table above) | | QUANTITY |
| | | |
| | | |
| | | |
| | | |
| | | |